

NRS NATIONAL REAL ESTATE SERVICE

NORTH AMERICA'S *Finest* REAL ESTATE MARKETING SYSTEM

NRS BRAND REALTY INC., REALTOR
AN INDEPENDENT MEMBER BROKER

873-0300

45 Mountainview Rd. N., Georgetown

FRED HARRISON — Sales Representative

MILLIE ADAMS — Sales Representative



FANTASTIC OLDER HOME

In Park District. 3 bedrooms plus large loft; eat-in kitchen. Ideal home for entertaining with spacious living room and dining room. Attached in-law one bedroom for extra income. Asking \$269,900. Call Fred or Millie.



BRAND NEW

Spring possession for these 2 storey four bedroom homes. Ground level family room and laundry room. 1/2 acre lots in village location. Choose your colours, cupboards, etc. Asking \$229,900.

Introducing:

SINCLAIR PLACE INDUSTRIAL PLAZA



The first industrial condominium in Georgetown. Located at Sinclair & Hwy. 7. Completion in late Spring 1988.

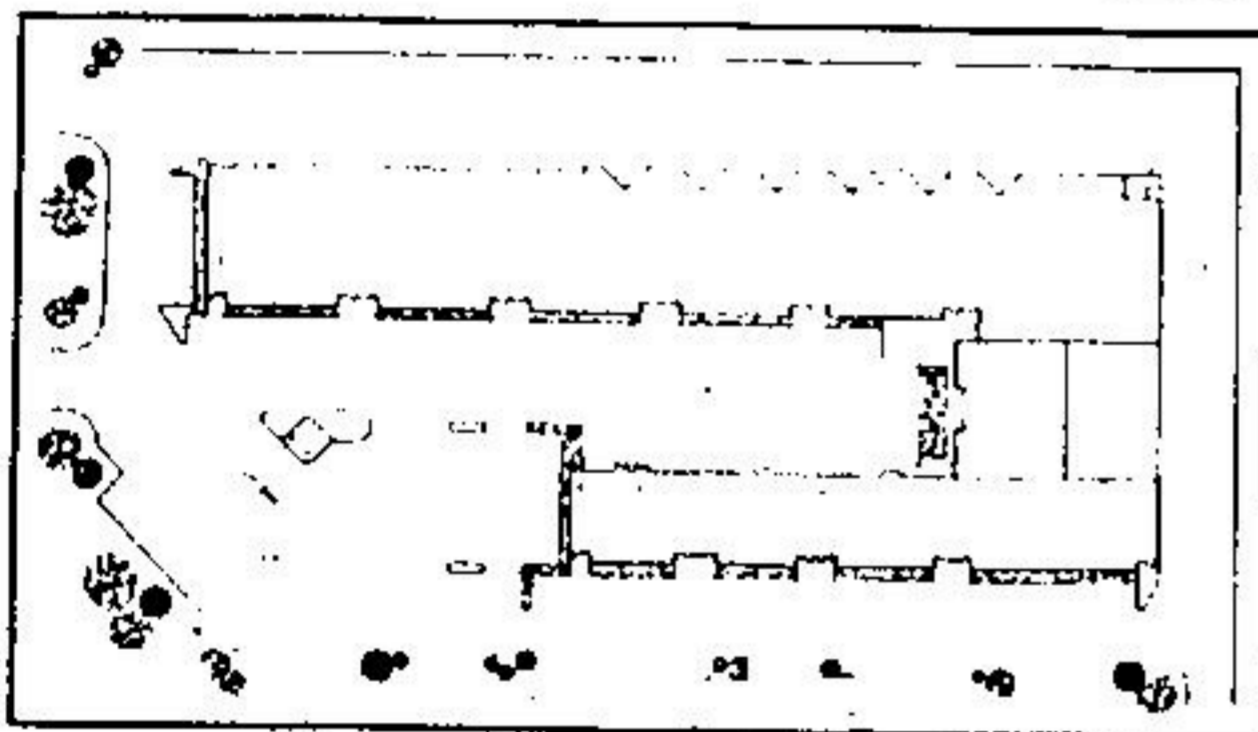

From 2000 sq. ft.
16' Clear Height
Sprinklered
12' Overhead Doors



OVER 80% SOLD

THE SANDS

Luxury Condominiums

HURRY Still some choice suites available
Situated on six gorgeous areas overlooking the ravines of the Credit River

Your passport to a new life

- | | | |
|-----------------|----------------------|------------------------|
| 5 Appliances | Exercise Room | Barbecue Area |
| Luxurious Lobby | Hobby Room | Sauna/Whirlpool |
| Lounge | Landscaped Gardens | Tennis Court |
| Party Room | Indoor Swimming Pool | Live In Superintendent |
| Air Conditioned | Sun Deck | |

Priced from \$99,500-\$146,500

NOW BUILDING

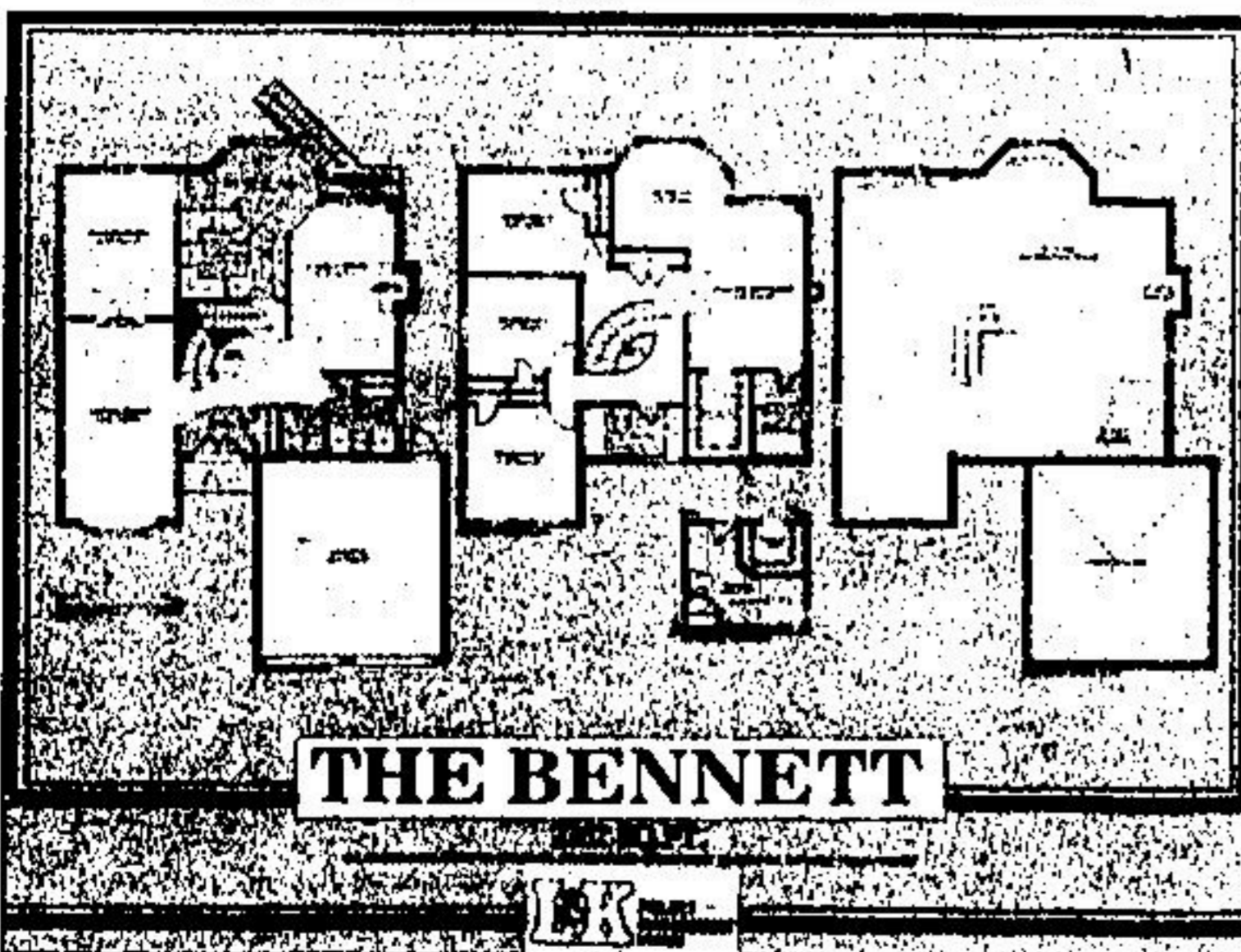

THE BENNETT

2262 SQ.FT. Deluxe features in a striking four bedroom design. Take exceptional pleasure in receiving guests into a foyer that is grand and elegant. The combined living/dining room offers great entertainment space. And everyone can retire to the dramatic family room and relax around a cozy log fire. The family room also offers a wide open view of the breakfast area which has a bright solarium style bay window. The kitchen has an unusual angled work/serving counter and is a gourmet's delight. Upstairs, the vast master is nearly 300 sq.ft. and includes a parents' retreat with a cozy bay sitting area. The master also includes a walk-in closet and full ensuite bath. Add an extra touch of luxury with an optional luxury ensuite.

\$279,900⁰⁰

45 MOUNTAINVIEW RD. N. GEORGETOWN

BUS.
873-0300

HOME
877-1283

NRS NATIONAL REAL ESTATE SERVICE

NORTH AMERICA'S *Finest* REAL ESTATE MARKETING SYSTEM