

**Legion Lines, by Greg Ball**

# Branch 120: the way things were

Sick List: Theresa Harrison, Sam Gisby, Len Rayner and Roy Haley. All in Georgetown Hospital.

Entertainment in the Lounge for Aug. 7 will be the Pubtones.

Friday August 13, Steak BBQ, 8 to 12. At \$5 each. HISTORY OF BRANCH 120

Reeve Martin Near was present to express congratulations of the town council and a sing-song was led by a familiar face, Harry Halwe.

Legion secretary Col. Shields, then spoke briefly. The meeting closed with the president thanking all present for their cooperation. The evening seems to have imbued everyone with high hopes for the future of the group.

A solemn event came to pass almost immediately on the death of a charter member, J.S. Fry, who passed away May 1, 1928, in Glen Williams. Twenty-two members accompanied by 18 ex-servicemen were present at the funeral, conducted by the president, using the Legion service.

From the opening night of the banquet events seem to have transpired quickly. Various committees were set up, visits paid to neighboring branches, and a set of by-laws was drafted. It is interesting to note that said by-laws were so soundly based that today, on revision of the same, only two minor changes were necessary. The familiar names noted among those who joined at that time are legion, and too numerous to mention in these pages. Meetings were held at first either in the Town Hall, old Waterworks building or private homes. Attendance at meetings seemed very good, with an average of 30.

To Be Continued.

**CHATELAINE LIGHTING**  
SERVING QUELPH AREA SINCE 1969  
RESIDENTIAL - COMMERCIAL  
SEE IT ON DISPLAY NOT IN A CATALOGUE WE ARE SHOWING BY THE 1988 PICTURE  
FULL RANGE OF TRACK LIGHTING SYSTEMS  
COMPLETE LINE OF OUTLINE HOUSEHOLD PRODUCTS  
348 YORK RD. QUELPH  
824-0401

**RENT OR BUY SOFT WATER**  
FREE INSTALLATION  
For more information We are 1/3 closer as your telephone  
**BOYES PLUMBING**  
855-4232

# HOME OF THE WEEK

**B. PICARD**  
ALCAN  
Aluminum Siding  
Home Improvements  
Soffit/Fascia/Roofing  
5" Seamless Eavestroughs  
Windows & Doors  
FREE ESTIMATES  
877-8247

**E.S.L. CARPENTRY**  
Specializing in HOME RENOVATIONS  
Experts in Kitchen & Rec Rooms  
Reasonable Prices  
878-5104

**DELREX Aluminum Limited**  
Aluminum Awnings  
Eavestroughs  
Siding  
Canopies  
Storm Doors  
Windows  
Soffit Fascia in Living  
Colours  
Specializing in replacement windows & patio doors  
877-5383

**BUYWISE WINDOWS & DOORS**  
FACTORY OUTLET  
Complete Line of Energy Saving WINDOWS AND DOORS  
- WE INSTALL -  
"The Place To Save!"  
73 MOUNTAINVIEW RD. N. UNIT 5, GEORGETOWN  
877-1186

**J.C.P.**  
877-1158  
PLUMBING & CONTRACTING  
Residential Plumbing  
Alterations, Additions  
Rec Room Conveniences  
Anywhere - Please Phone  
877-1158

**B.A.M. Construction Ltd.**  
Home Improvements  
Renovations - Alterations  
Carpentry  
Eavestroughing  
Siding - Roofing  
FREE ESTIMATES  
794-0383  
all work guaranteed

**MEL TAYLOR ALUMINUM LIMITED**  
FEATURING  
Energy Efficient Replacement Windows  
Patio Doors & Storm Doors  
Aluminum Home Improvements  
20 YEARS EXPERIENCE  
877-6772

**JOHN CAMPBELL LANDSCAPING**  
Professional Design  
Retaining Walls  
Planting  
Sodding  
Mulching  
Sodding and Overseeding  
Tree Pruning & Surgery  
Complete Landscape Maintenance  
873-1116  
451-8025 Brampton

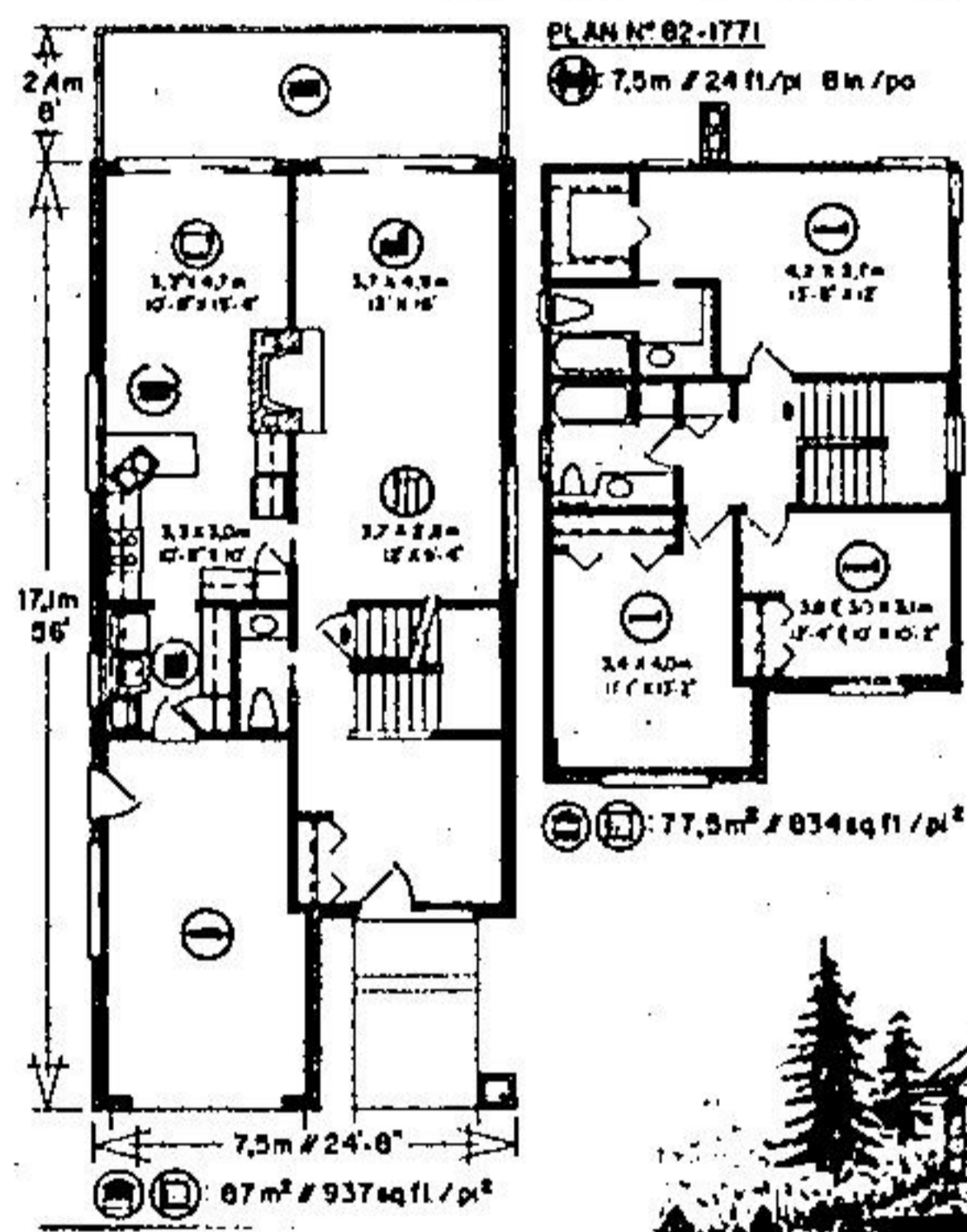

**URBANE TOWN-HOUSE IDEAL FOR NARROW URBAN LOT**

This imposing two-storey home design is perfectly suited to the very narrow frontage residential building lot and provides nearly 1,800 square feet of logically-arranged finished floor area on its two levels. A full basement provides abundant space for the future development of additional accommodations and/or recreational facilities. The impressive exterior is finished in mixed brick veneer and horizontal channel siding; with arched and shuttered second-storey windows, brick chimney and shingled roof. Alternate exterior finishes may be applied according to regional availability of materials, local costs and individual homeowner preferences.

The weather-sheltered main entry leads into a spacious reception foyer and outerwear storage area, which contains a two-piece guest vanity bathroom behind a convenient pocket door. From the foyer, traffic moves forward, past the stairways to the second level and the full basement, to the long rectangular living-dining room combination. The living room features a raised-hearth masonry fireplace and a sliding glass walk-through leading onto the full-width rear balcony. The dining area separates from the kitchen via convenient pocket door, for ease of access when entertaining.

A well-organized double L-shape or box-plan kitchen provides a step-saving work triangle configuration, generous countertop work surface and abundant cupboard storage facilities. The kitchen divides from the dinette and family room by means of a short work counter, which latter could easily be developed as a small snack-bar counter, for the family which prefers light snack dining. The family room features full-width sliding glass doors which provide easy access to the wide rear balcony, for outdoor dining in fine weather.

A convenient laundry facility and mud room area, positioned between the single-car enclosed

garage and the kitchen provides for a side-by-side configuration of washer-tub-dryer and a long laundry-folding counter.

All three bedrooms are positioned on the second level, accessible via stairway from the main reception foyer. Each of the bedrooms has good exposure for view and natural light, and each possesses ample closet storage facilities. The spacious master bedroom features a full walk-in closet and a three-piece ensuite bathroom with tub behind a space-saving pocket door. For greater convenience, the tub and commode could easily be separated from the vanity area by means of either a pocket door or bi-fold doors, thus greatly enhancing the convenience of the ensuite.

The entry and upper hallway are lit naturally by a tall window on the landing, adding a sense of spaciousness and vertical dimension.

Plans for design No. 82-1771 may be purchased either by the single set, at a cost of \$130.00 for the first set and \$25.00 for each additional set, or by the package. A five-set plan package, including the first set, is economically priced at \$185.00 and an eight-set package, also including the first set, is only \$225.00.

Whichever method you choose, please include \$9.00 for postage and handling.

Send for the current edition of Select Homes magazine, series 52, featuring imaginative decorating and home improvement ideas, plus 260 quality home plans of every type. Available for \$3.25 (\$2.00 plus \$1.25 postage and handling).

To order any of these items please send cheque or money order, payable to the Home of the Week. Address to: Home of the Week, c/o The Halton Hills Herald, Unit 1, 151 Carlingview Drive, Rexdale, Ontario, M9W 5E7.

**JACK'S HOME SERVICES**  
Complete Home Renovations  
Small Home Repairs  
Storm Windows  
Custom Built Kitchens  
873-1311  
(Georgetown)

**CUSTOM PROFESSIONAL CARPENTRY**  
**C.P.C. CARPENTRY**  
All phases of carpentry  
Solar Additions  
Custom Homes  
Additions & Renovations  
NO JOB TOO SMALL!  
Free advice & estimate  
877-5655

**AQUAFINE WATER SERVICES**  
WATER SOFTENERS AND WATER TREATMENT EQUIPMENT  
LOW MONTHLY RENTALS  
FREE WATER TESTING & SERVICE  
348 Guelph St. 877-6242

**VINCE BURT CARPENTER**  
Thinking about a project in the future. We guarantee our quotes not to change before APRIL 1983  
Additions & Garages  
Renovations & Rec Rooms  
The & State  
FREE ESTIMATES  
853-1159

**LEON'S ROOFING**  
All types Shingles, Flat  
New work - Repairs  
ALSO EAVESTROUGHING & SHEET METAL WORK  
24 HR. EMERGENCY SERVICE  
877-4124

**TOPLINE**  
Painting & Minor Home Repairs  
FREE ESTIMATES  
877-2868  
877-5940

**LOSE 17 TO 25 POUNDS IN JUST 6 WEEKS**  
CALL TODAY FOR A FREE CONSULTATION

**DIET CENTER**

70 MILL ST.  
877-2900  
877-2277  
HOURS:  
Monday to Friday  
8:00 a.m. - 12:30 p.m.  
3:30 p.m. - 6:30 p.m.  
Saturday  
9:00 a.m. - 12 Noon  
Nutritional Behaviour Classes  
Thurs: 7:30 p.m. - 9:30 p.m.