

# CO-OP

# INTRODUCES THE U-CAN-DO GARAGE

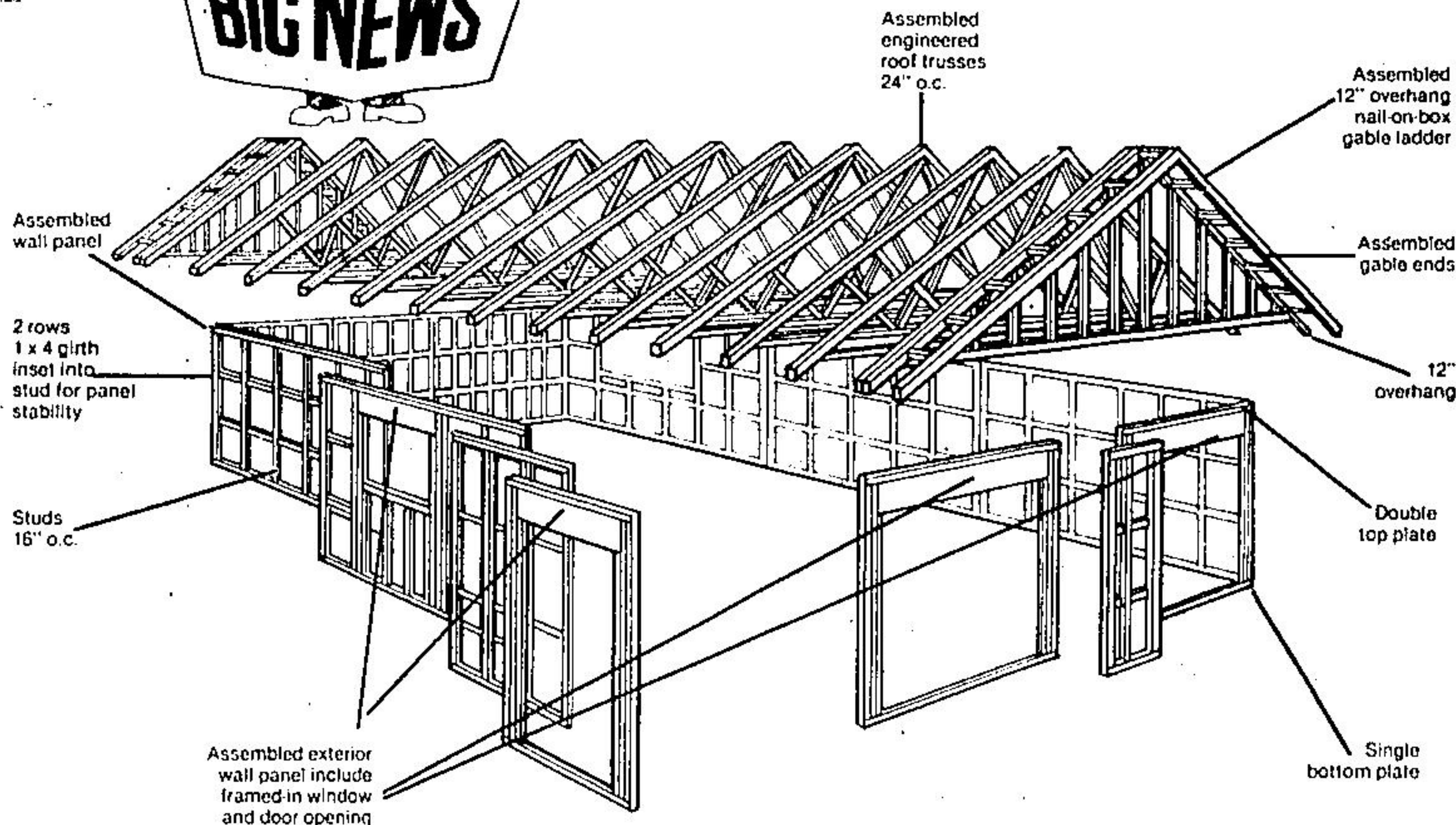

- all first quality kiln dried spruce
- easy-to-handle wall panels 2', 4', 8'
- panel coder for easy, instant erection

CO-OP Introduces the 'U-Can-Do Garage'. A giant breakthrough in custom designed garages. Now it's as easy as ABC to erect a garage that fits your lot size with no sacrifice to your individual requirements. How? With easy-to-install panels that are constructed of No. 1 grade kiln dried spruce. The panels are available in 2', 4' or 8' widths with door openings, window openings or no openings. Now, the only thing that dictates how many windows you get is your own individual preference.

It's a revolutionary concept in shell erection that requires no special tools and no special skills — all you need to know is your ABC's and have one free weekend. Once your shell is up you can finish it any way your budget and taste calls for. The sturdy shell with all the above features readily takes aluminum siding, steel siding, wood or sheathing. So don't put off building that garage any longer. Bring in your design to a CO-OP representative and he will put together a 'U-Can-Do Garage' package for you.

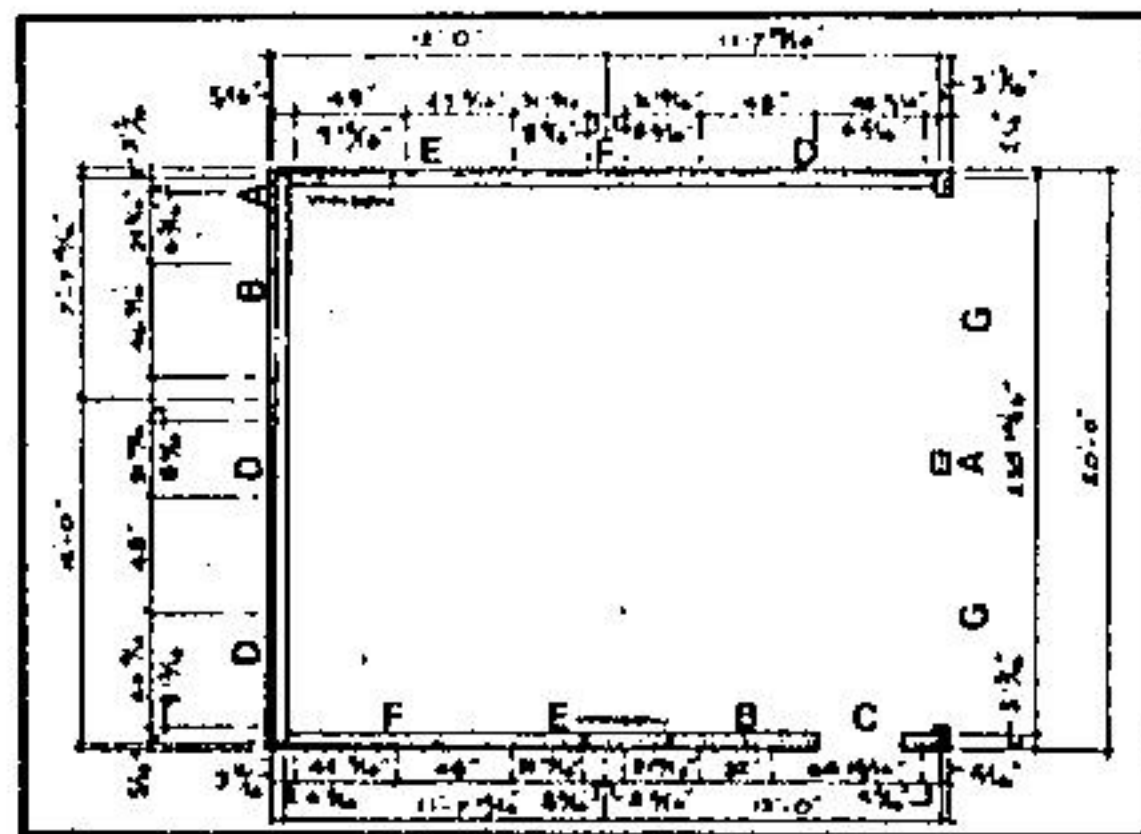

Double car garage plan can be made with one large roll-up door or two single roll-up doors. The choice is yours. From the illustration you can see that wall components are interchangeable so the side door and window can be located on either side of the garage.

MEET THE PROFESSIONAL AT YOUR CO-OP.

**Susan Hamilton**  
Georgetown

READY TO BUILD?  
See me for competitive pricing and expert advice.

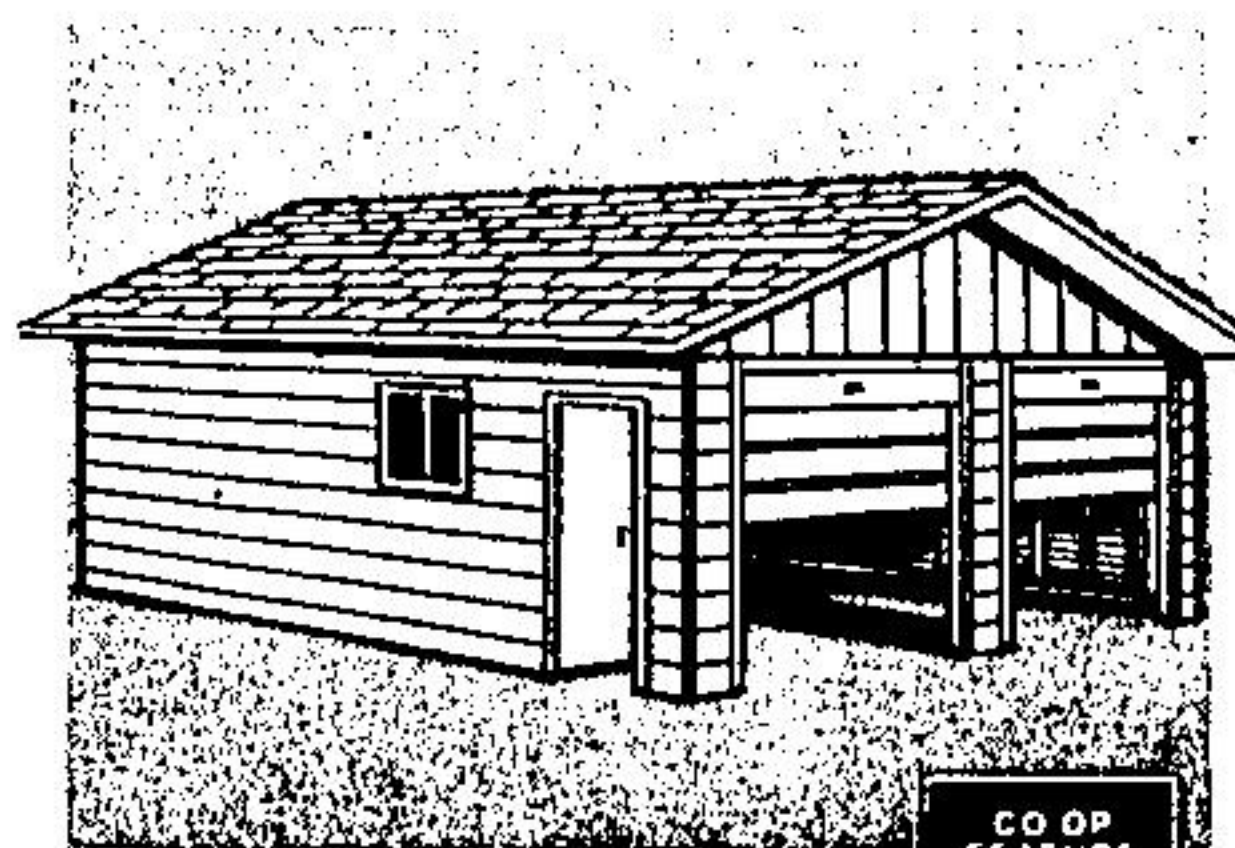

Finished Garage: Finish it the way you want. Example: 20'x24' finished with vinyl siding; 210 lb. shingles; one-piece steel garage doors.

CO-OP FEATURE VALUE  
**\$3,350<sup>00</sup>**

EVERYONE WELCOME TO SHOP CO-OP...QUALITY PRODUCTS...COMPETITIVELY PRICED



333 GUELPH ST.  
GEORGETOWN

877-2271

