

Illustrated Above: Our "KAWARtha" Style Kitchen Cabinets.
Below: Our "PIONEER" Styling.



PLUMBING!

STAINLESS STEEL SINKS



SINGLE
Model No. 300
With Strainer.
18" x 20".
(Less Ledge)

\$22⁸⁸

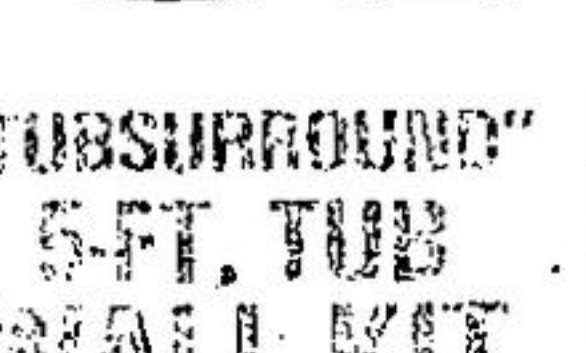

DOUBLE
Model No. 3221
With 2 Strainers.
32" x 21".
(as shown)

\$52⁴⁸

"TUBSURROUND" 5-FT. TUB WALL KIT

\$69⁹⁵
EACH

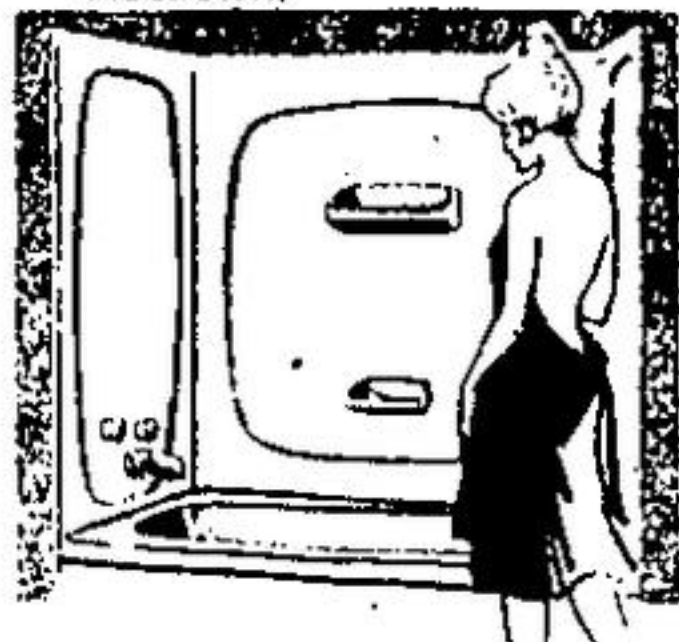

3-Pc. Kit to cover old walls, make your bathroom look like new again. White ABS Plastic. 5'x5' Back Panel and two Side Panels each 5'x30". Complete with all materials for installation.

IMPROVED 5-FT. TUB ENCLOSURE

\$112⁰⁰



ONE DOOR IS A FULL SAFETY GLASS MIRROR.

A glamorous yet practical addition to your Bathroom. Two sliding doors including one that's a full Mirror made of Safety Glass and Waterproofed with a special backing. Heavy Duty Aluminum framing in bright anodized Silver colour finish. Extra wide Towel Bar.

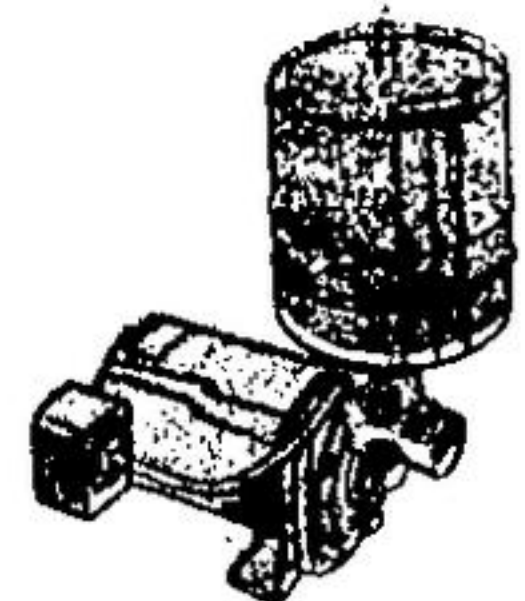

"THE COTTAGER" 1/3 H.P. SHALLOW WELL WATER PUMP

Value From "GSW"

\$139⁹⁵

Features include Built-in Ejector; ABS Foot Valve; Pressure Switch; Polycarbonate Impeller; 5/8 John Crane Seal; Cast Iron Casing. 1/3 H.P. 115-Volt Motor.

ABS/DWV DRAIN PIPE PER 12-FT.

CSA APPROVED! 1 1/2" **\$4.88**

Easy installation for the Do-It-Yourselfer. No soldering is required.

3" **\$12.65**

SEWER PIPE PER 10-FT. LENGTH

AS AVAILABLE 3" **\$3.25**

Solid or Perforated Sewer and Drain Pipe. Polyethylene with Bellied Ends.

4" **\$4.75**

PEERLESS "MESSAGE ACTION" SHOWER KIT

A personal Hand Shower you can dial for Pulsating Massage Action or Conventional spray. Fits 1/2" shower arm.

\$17⁸⁸
EACH



CANADIAN GENERAL ELECTRIC KITCHEN BUILT-INS!

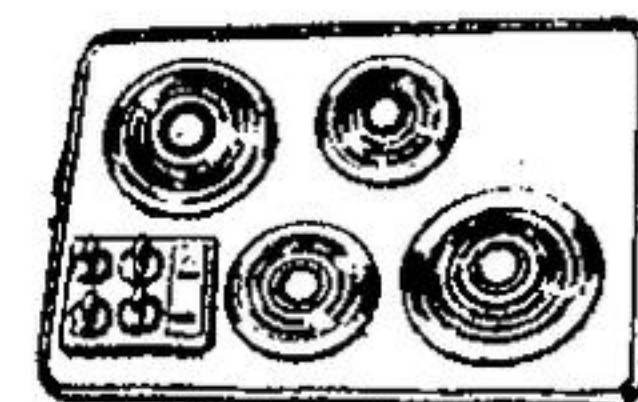

Model 63J81

SURFACE UNIT

Brushed Chrome finish. Infinite Heat Controls. Indicator light. About 21-3/8" x 30-3/4".

OUR PRICE **\$195⁰⁰**

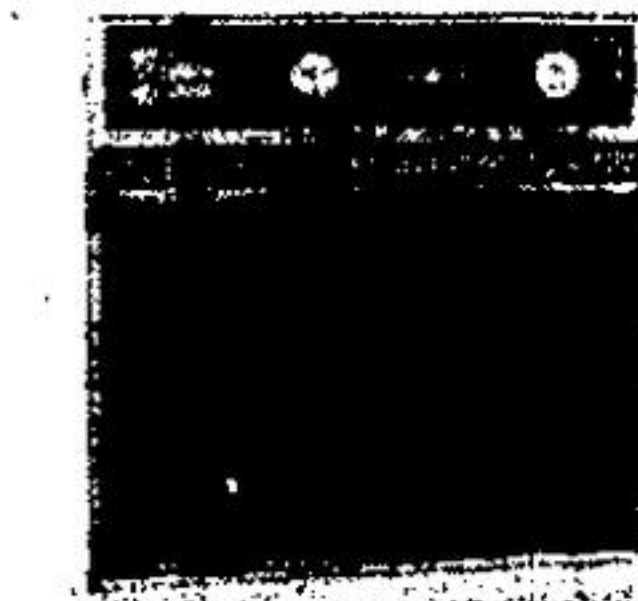

Model J53CM

WALL OVEN

Automatic Oven Timer, Clock and Minute Minder. Elegant black glass door. Oven light. Broil pan and rack. About 21" x 15" x 17-1/4".

OUR PRICE **\$349⁰⁰**



RANGE HOODS

30" Ducted "X" Series with Light and 2-Speed Fan. Streamlined styling. Colours as available locally.

OUR PRICE **\$38⁸⁰**



COUNTER TOPS

\$2.99 PER FOOT AND UP!

Stock Colours, Patterns, Sizes, as available locally. End caps extra. A wide selection including choices for Kitchen and Vanity Cabinets.

HEY! LOOK US OVER

CASHWAY'S THE STORE

MANUFACTURED TO C.S.A. STANDARDS OF QUALITY!
OUR OWN "PETERBOROUGH LINE"



KITCHEN CABINETS

MODULAR UNITS YOU SELECT TO PUT TOGETHER YOUR VERY OWN KITCHEN.

AVAILABLE ON ORDER OR FROM STOCK TO MEET YOUR PERSONAL NEEDS!

BONUS 5-PIECE SINK OFFER!



OFFERED WITH KITCHEN CABINET PURCHASE UNTIL SATURDAY APRIL 7th, 1978.

Order Prefinished Kitchen Cabinets Totalling \$800.00 or more during this Offer and We'll Give You The 5-Piece "K.I.L." Sink Package At No Extra Cost. The 5-Piece Package Includes 18" x 31" Stainless Steel Sink, Hardwood Drop-In Cutting Board, WALTEC "Elite" model Single Control Mixing Faucet, and Two Sink Strainers.

SINK PACKAGE IS A REGULAR EVERYDAY VALUE OF \$104.00

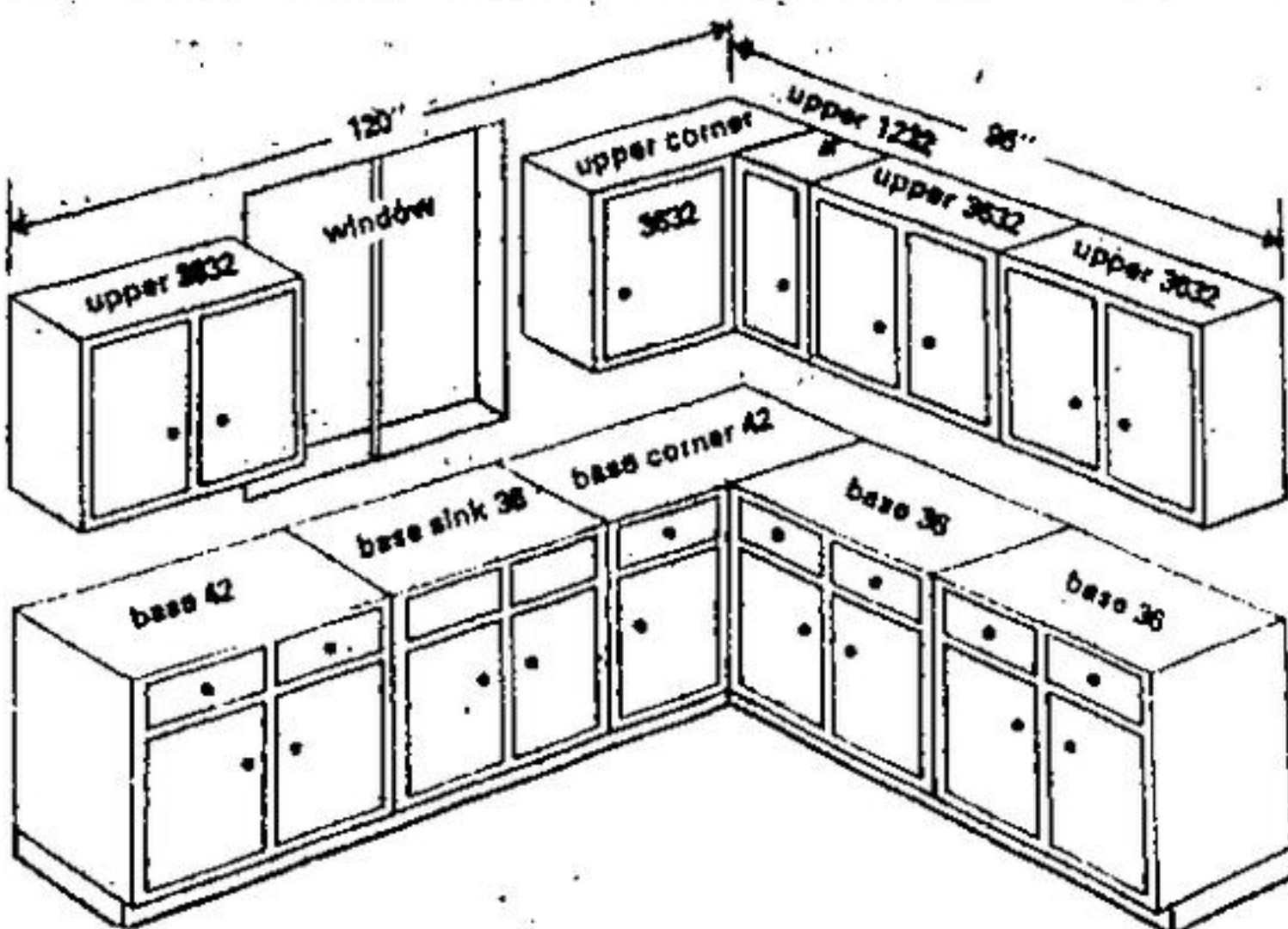

ILLUSTRATED IS AN 8' x 10' KITCHEN THAT
COULD BE A START ON YOUR OWN PLAN!

Cabinet sizes are as noted. Another arrangement or plan will raise or lower the total price to you. Self-closing Hinges on all doors. Many of the Upper Unit shelves are adjustable. Door and drawer handles are included in our low prices, or cabinets can be ordered undrilled for your own hardware. Counter Tops, Sinks, Faucets, etc., are not included in quoted prices, but are readily available to meet your needs.

CHECK OUR LOW PRICES

Three price ranges and a typical Kitchen Cabinet arrangement have been selected to give you an indication of the values available in our "PETERBOROUGH LINE" Modular Unit Kitchen Cabinet System. Six other styles including Natural Birch you finish yourself are available. And cabinet selections can range from as narrow as 9" to as wide as 48" and you can include Broom Closets, Lazy Susans and more! Ask one of our qualified kitchen consultants for the full details.

	PIONEER RED BIRCH	DALEWOOD STYLE	KAWARTHA STYLE
UPPER UNITS			
Three Units, each 36" x 32"	\$282.72	\$364.95	\$397.17
One Upper Corner Unit, 36" x 32"	\$81.63	\$104.28	\$113.40
One Upper Cabinet Unit, 12" x 32"	\$49.22	\$63.20	\$68.93
BASE UNITS			
42" Base Unit	\$136.41	\$174.69	\$189.86
36" Base Sink Cabinet	\$108.41	\$140.19	\$152.33
42" Base Corner Cabinet	\$104.53	\$130.83	\$141.83
Two Base Cabinets, each 36"	\$250.76	\$321.56	\$349.58
TOTALS	\$1013.68	\$1299.70	\$1413.10

9 STYLE CHOICES!

3 FEATURED RIGHT HERE

"KAWARTHA"

As illustrated. A bold new design with all the richness of Elm. Raised panel doors display rich grain detail and are accented by brass-finish hardware.

"PIONEER"

As illustrated. A country kitchen look of old-time quality in selected Red Birch. Beautiful Colonial/Traditional styling.

"DALEWOOD"

Not illustrated. Featuring door and drawer fronts finished in American Elm, Light Cherry or Dark "Bolero" finish.

FREE KITCHEN PLANNING SHEETS

Available At Any Of Our Centres. A Good Way To Get Started On Your New Kitchen.

LET US HELP WITH YOUR PLAN

Bring us your Kitchen Measurements and the other details called for on the Kitchen Planning Sheets and we'll help with cost estimates, style selections and professional advice.

INSTALLATION ARRANGEMENTS AT MANY CENTRES!

Check locally. Many of our Centres now are able to make available arrangements to install the Kitchen Cabinets you purchase from us. If the Centre in your area features this service, details and charges will be supplied to you on request.

"SHARP" MICROWAVE OVEN WITH "CAROUSEL" COOKING SYSTEM... COMPARE IT FOR VALUE!

C.S.A. Approved Model No. R-6780C Lets You Cook Either By Time Or Temperature Settings!

OUR PRICE **\$619⁹⁵**

The 14-1/2" dia. "Carousel" work like a turntable to move food around and through the microwaves for quick even thorough cooking every time. VARIABLE COOKING CONTROL including DEFROST, SIMMER, ROAST and Full Power Settings. PURE COOKING CONTROL with Meat Probe for succulent Roasts, Turkeys, etc. Large 1.2 cu.ft. capacity with easy-clean Stainless Steel interior. Interior Light Digital Timers and "Auto-Start" automatic features. Complete with deluxe "SHARP" Microwave Cook Book.

* SHARP Warranties include 2 years on Parts and LABOUR. 5-Year Warranty on the Magnetron Tube.

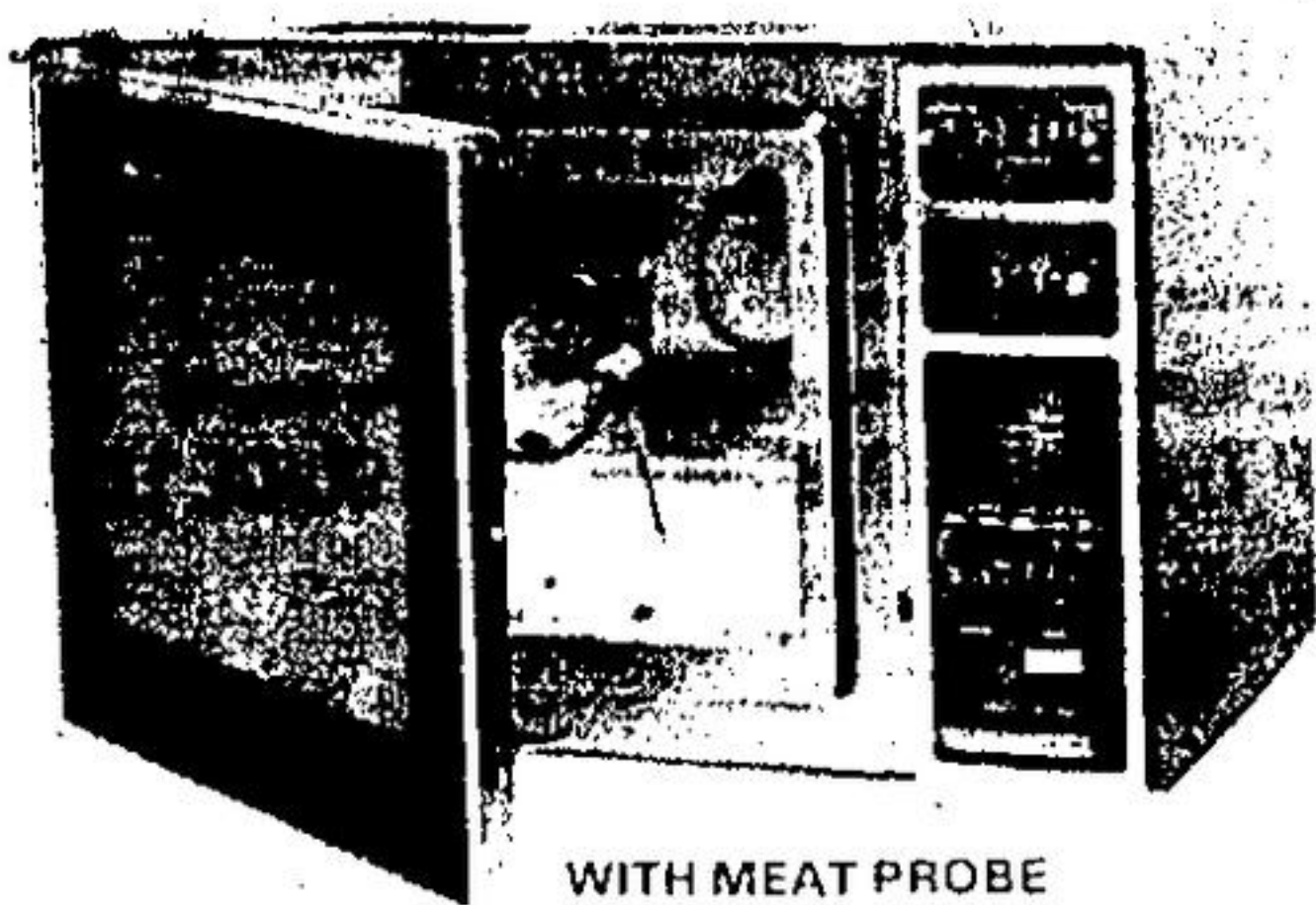

WITH MEAT PROBE