

# HOME



Attached to underside of branches, these caterpillar-like sawflies become conspicuous in late May through early June. Damage to heavily-infested maples may be severe. Branches are killed, foliage turns yellow and the vigor of the tree is reduced. The sticky honeydew creates problems on sidewalks and cars parked under suffering trees.

PHOTO BY THE DAVLEY TREE EXPERT CO.

## Tree-brand popcorn

After one of the longest winters ever, spring has finally arrived with its colorful blooms, lush green foliage and popcorn. Popcorn?

Yes, if you have a maple tree in your yard, there's a chance the tree may be infested by Cottony Maple Scale. Not a disease, but an insect that is prevalent throughout the United States and much of Canada. Its favorite host is the Silver Maple, but other maples and deciduous trees are subject to attack.

Currently, the insect appears as a small, light brown shell on the undersides of branches. But soon, the overwintering scale will begin laying eggs. The eggs will be covered in a hollow white sac which resembles popcorn, or a cotton ball, hence, its name.

## In-town garden plots

If you have a craving for home-grown vegetables but lack garden space, a community garden plot may be the answer.

Many Ontario municipalities have made good use of public land for community gardens, says Russ Gomme of the Agricultural and Horticultural Societies Branch, Ontario Ministry of Agriculture and Food.

At most community gardens, the land is prepared for planting and water is provided. After renting a plot, you are responsible for planting, weeding and watering when necessary.

"First time gardeners should start with a small plot and plant a few of their favorite vegetables," says Mr. Gomme. "Try two or three varieties of tomatoes, beans, radishes, corn and cucumbers so you will have several fresh crops during the summer."

He also suggests planting a row of beets and carrots and a row of several varieties of corn, if there is room.

In addition to providing fresh vegetables, community gardening gives you opportunity to learn about gardening and meet other members of your community.

For beginners, the advice of a seasoned gardener can make the difference between success and failure.

"Community gardening, although popular in Europe, has a relatively short history in Ontario. It has just started to catch on here in the past five years."

For more information about community gardens in your area, contact local municipal offices, parks departments or horticultural societies.

then concentrate on reproducing. If left untreated, damage is often severe. Branches are killed, leaves turn yellow, and the vigor of the tree is greatly reduced. Also, a sticky substance known as "honeydew" is given off by the feeding insects, which is a problem for patios, sidewalks, or cars parked under ailing trees.

According to Henry Gilbertson, Director of Technical Services, of The Davey Tree Expert Co., "trees weakened

by 'scale' become vulnerable to environmental factors they normally could withstand." To control Cottony Maple Scale, infested trees must be sprayed all over, taking care not to miss any affected areas, particularly the undersides of leaves.

Mr. Gilbertson of Davey Tree said, "We recommend spraying twice in July to maximize odds of controlling this dreaded tree pest."

## Bring outdoors indoors with beautiful mural

Equestrian or hot shoe skier - it feels great to be a part of Mother Nature. Spinning from East to West, America has reaped the pleasurable rewards of actively participating in a myriad of exhilarating activities.

The great attention for our environment has been reflected by recent trends in contemporary home settings.

The return to warm and earthy tones and the revival in the use of natural materials including bamboo, rattan and wicker has created a flurry of simple yet classically executed designs.

Additionally, the renewed interest in flora and fauna has helped to reinforce this back to basics feeling.

Have you ever thought of

bringing the magic of the great outdoors into your living room with a wall mural such as Photowall from Scandinavia? Available in full color or black and white, Photowall is washable and comes in ready cut sections and with just the right amount of adhesive for easy installation.

Produced on high quality art paper, these mural wall coverings can assist city and country dwellers alike in recreating nature's wonderland in any room of the home.

Home interiors have been brightly accented by the return to things past. Now you can offer family and friends a window on the world with Scandinavia Photowall's fresh, Scandinavian

## Egyptian grandeur is captured for the modern home decorator

Egypt has captured the limelight! For the first time in history, a collection of glorious treasures unearthed from King Tutankhamun's tomb is on view in American museums.

Tut's royal treasures reflect the brilliant artistic heritage of Ancient Egypt, and the grand style which has influenced design through the ages. Even today, Egyptian motifs have inspired new developments in fashion and home furnishings.

You may not be furnishing an interior the majestic size of a pharaoh's pyramid or a presidential villa along the Nile, but you can still bring the grandeur of Ancient Egyptian motifs into small scale living quarters by suit contemporary decorating needs.

Whether you rent or own, living space is becoming more expensive every day and this means every square foot must be used wisely. The convertible sofa provides one economical solution for space savers by being functional as well as decorative.

Now you can sleep in the same area where you read, watch TV, or entertain guests, enjoying the luxury of two different rooms for the price of one!

Engineering innovations in the new sofa-bed lines make these pieces even more desirable for contemporary interiors. Gone are the days of bulky, cumbersome, uncomfortable, those constant reminders that you had a mattress hidden in your living room.

Sleep up-to-date styles are made to enhance, not dominate interior decor, and to make a fashion statement.

Now an important statement in home furnishings is



BRING THE GLORY OF ANCIENT EGYPT right into your own living room with Simmons' "Taurus" Hide-A-Bed sofa, featured in its exclusive "Theban" collection. A gently pitched arm suggests traditional pyramid shapes, while a loose pillow back provides up-to-date styling and comfort. The Egyptian theme is completed with bronze and terra cotta fabric in the "Baskets" pattern, created by Jim Patterson of Perennette Concepts in concert with the Metropolitan Museum of Art. Room setting design is by Douglas Sackfield.

Egyptian, reflecting the tremendous impact Egyptian art has had on design throughout history. Convertible manufacturers, like the Simmons Company, have designed new frames inspired by Egyptian forms and chosen high style fabrics expressing complementary motifs.

This fashionable marriage of fabrics and softened frames is an advantage for the kind of small scale decorating that most of us face. A well designed piece becomes the focal point of a room without filling it entirely, and it can integrate all the other decorative elements to create a total look.

If the Egyptian look is your style, a convertible sofa-bed like Simmons' "Taurus" Hide-A-Bed from the exclusive "Theban" col-

lection features a frame which combines the low, lean look of contemporary styling and a traditional motif - gently pitched arms suggesting pyramid shapes.

Offered with a complete line of designer created Egyptian fabrics, the model creates a compact oasis of elegance. All of this without sacrificing sleeping comfort, since the "Taurus" is available with a 58" x 75" queen sized mattress, or a 65" x 75" super queen.

What better way to end a bedtime story than with a convertible that neatly tucks itself in a tight back into your style, a convertible piece, and a money saver, which allows you to get the most value and enjoyment from your own living space.



LAWRENCE PEABODY, A.S.I.D., WELL KNOWN product and interior designer, uses rattan and wicker furnishings from his Larry Peabody Collection by Grede Wicker to complement this exotic and elegant floral wallcovering from the "Galleria" collection by General Tire.

## Top designer contrasts color and texture for rich new look

Lawrence Peabody, A.S.I.D., internationally renowned product and interior designer with homes and offices in Denmark, New Hampshire, New York and Haiti, lent his unique creative flair to a light and airy yet sophisticated apartment.

The highlight of this luxurious living room, designed by Lawrence Peabody, A.S.I.D., is his blend of exotic and elegant wallcovering designs with the natural look of rattan and wicker. Haitian cotton and lush tropical plants, accented with pieces from a collection of primitive art.

The elegant floral wallcovering, Capriccio, from the "Galleria" collection by General Tire, provides a colorful backdrop for the simple lines and natural colors of the furnishings from the Larry Peabody Collection by Grede Wicker.

As Peabody explains this design, he wanted to use richness and pattern in one area, counterpointed with natural colors and objects in other areas. "For me," Pea-

body acknowledged, "it's a very new and exciting design concept."

The appeal of these hand "some" wallcoverings is enhanced by the hand printed look of expensive papers and the durable "livability" of easy to care for vinyl.

Combined with the ease of modular furniture, which can be arranged to suit any mood or purpose, this room becomes a versatile, elegant living area.

## Naturals and neutrals



THE GRADUAL, BUT DEFINITE, swing to naturals and neutrals has pervaded all areas of home furnishings. The result is a calm, yet sophisticated approach that gives period pieces a more contemporary look. What better setting for family fare or feasts for friends than this romantic Treasury II dining room group by Stanley Furniture Co. The style is Country European with the deep honnet on the china cabinet to rich detailing outlining door and drawer panels; graceful cane-back chairs and double pedestal base supporting the dark-toned table top. Stanley has given this group a more contemporary look with an antiqued buff finish. This warm honey tone follows the trend to neutrals and naturals, while the furniture design itself still presents comfortable links with the past.

## Good living

Good living quite naturally includes all the extras - large and small - which make the home as fun and entertaining as it possibly can be.

With all the new advances made in home entertainment to soothe the senses, highest quality sound, perfect picture selection and control electronic games to stimulate - it's no wonder that people are finding more and more reasons to stay at home!

**AGRICULTURAL LIME SPREADER SERVICE CAMPBELL'S LIME SERVICE**

Wherever you are, you're not too far!

R.R. 8 Brantford, Ont.  
 BUS. (519) 647-3448 RES. (519) 647-2320  
 The cost is not so much to build your soil up!

**SAVE 15%**

Beautiful Laminated Kitchen Cabinets including post-formed counter tops at 15% savings if purchased before June 30, 1978.

Call us today at 877-0244

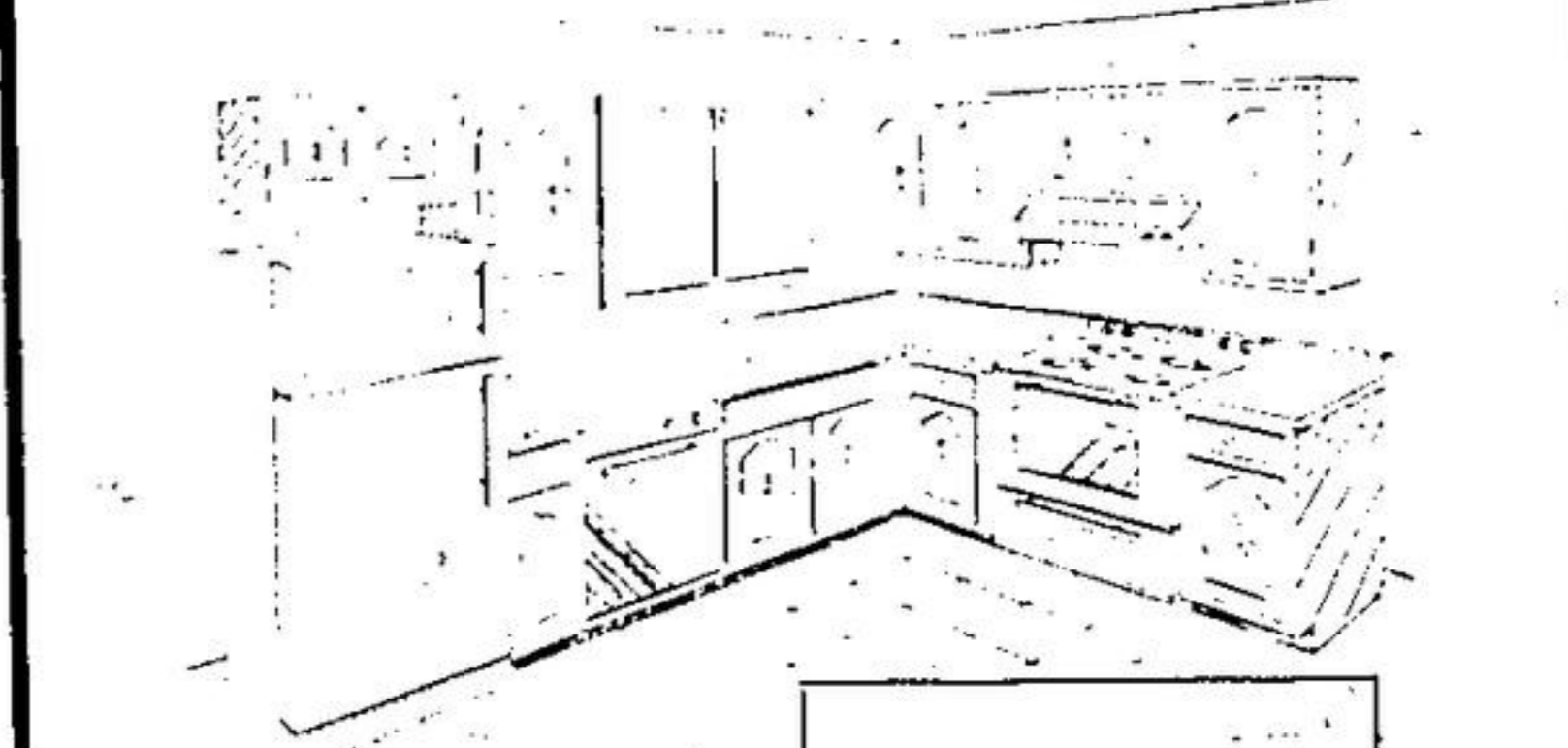

LET US DESIGN YOUR KITCHEN AT NO CHARGE

Beautiful laminated cabinets including post formed counter top for typical kitchen shown above

**UNDER \$800.**

PLUS TAX, BEFORE JUNE 30, 1978

- Laminated cabinets never lose their beauty.
- Easy to clean with damp cloth.
- 3 styles in 3 colours to choose from

Let Us Design Your Kitchen at No Charge

SAVE HUNDREDS OF DOLLARS

- Buy laminated cabinets and Save 15 percent
- All other cabinets save 10 percent.
- Install them yourself and save hundreds more.
- Buy before June 30th and Save 10% or 15%
- Offer expires June 30, 1978

CALL US TODAY

**the Cabinet Answer LTD.**

GEORGETOWN 877-0244 CHARGEX VISA BRAMPTON 456-0580

Guelphview Square (next to Neptune Restaurant) Squire Mews Plaza 239 Queen St. East (Behind the Crock & Block Restaurant)

"It saves to do your own installing" we'll show you how

J. Bowles Slove Co. Goes for the Outdoors with

**PATIO FURNITURE and GAS BAR-B-QUES**

Come in and see our selection of Patio Lounge Furniture and Propane Gas Bar-B-Ques by Falcon.

**PATIO SPECIAL**

2 Wrought Iron Chairs & round Patio table (white) Reg. \$49.95 **39.95**

**J. BOWLES** Stove Co. Ltd. 71 Mountainview Road North, Georgetown 877-0551

Everything You Need Just 3 Minutes from Downtown Georgetown

**MOUNT BATTEN JUNIPER** Reg. \$9.95 \$15.00

**GLOBE CEDARS** Reg. \$10.40 \$7.50

**AUSTRIAN PINE** Reg. \$19.70 \$13.75

**RASBERRY CANES** Reg. 43c 3 for \$1

**ROSES** Potted & flourishing 12"-17" high Reg. \$3.40 **\$2.25 EACH**

ALSO:

Good Buys and Great Selection

- ★ LOCUSTS ★ APPLES
- ★ CRIMSON KING MAPLE
- ★ EMERALD QUEEN MAPLE
- ★ OLD GOLD JUNIPERS ★ BIBURNUM
- ★ UPRIGHT JAPANESE YEW
- ★ FLOWERING ALMOND

Aware of your needs... **Master Feeds**

R.R. 2, Georgetown STEWARTTOWN 877-3512