

PARADE OF HOMES

By MACK PARLIAMENT
Director of Publications
Canadian Real Estate Association
If urban growth continues at the pace that has marked the last century as Canada changed from an agrarian to an industrial country, by the year 2000 only 5 per cent of the population will be rural dwellers. At present 30 per cent of the population falls into that category the remaining 70 per cent are city dwellers.

Despite its almost 4 million square miles of territory, unlike the United States, Canada is not a nation of several large cities. In fact, if present trends continue, of the 95 per cent of the population who would be living in cities by the year 2000 most of them would be concentrated in three or four large centres like Montreal, Toronto and Vancouver and to a lesser degree in expanding cities like Calgary.

This trend has had a marked effect on the price of houses in the large cities affected by influx of people from rural areas and smaller centres. As the population of the urban giants increases, so does the price of houses. The reason is not difficult to find. As land surrounding these centres becomes scarcer, its price increases and it is not uncommon for the price of the lot on which a house stands to represent 50 per cent or more of the house-lot package price. It is an elementary economic law that scarcity exerts upward pressure on the price of commodities.

Therefore, it is easy to see why the price of houses in Vancouver is much higher than the national average. It is sandwiched between the ocean and the Rocky Mountains, making whatever land that is available an extremely valuable commodity.

Toronto likewise is waterlocked on its southern border, making land inside the city and on its northern border more valuable as vacant land within the city becomes rapidly depleted.

Calgary is also experiencing growing pains and this city with Toronto and Vancouver have the highest average house prices in Canada.

"The now familiar problems associated with urban living are going to multiply - especially if Canadian cities follow the pattern of many large U.S. cities," Marcel Lessard, federal minister of regional economic expansion, predicted in a recent speech.

Jobs and more house construction follow the concentration of plant locations and so the big cities get bigger and, Lessard said, the problems of congestion, pollution, personal alienation, serviced land shortages, housing problems and social unrest are inevitable.

Meanwhile, the population of many small communities across Canada has been falling as industry locates elsewhere. Some face the threat of virtual extinction. Property values fall as people move away and though there may be bargains they are not matched up with employment opportunities. But they may be bargains for retired couples or families prepared to commute.

In an attempt to turn the tide so that the present projections for the year 2000 won't become a reality the federal government has for some time intervened to try to better balance economic growth.

"There has been a concentration of plant locations in large urban centres to the point where Southern Ontario, for example, accounts for almost half of all Canadian employment and output in manufacturing industries," said Lessard. "These activities are expanding in that area at rates greater than those prevailing in the country as a whole."

Many examples of government intervention to encourage development of different parts of the country are a part of history. But

recent intervention, according to Lessard, has been designed "to promote greater freedom of choice for individuals and to increase the opportunities available to Canadians to work in different regions at different jobs offering long-term security and income stability."

In short the aim of the federal government is to encourage small communities to grow and prosper if they have the potential to do so.

Of course, taxpayers' money is spent to accomplish the government's objective in constructing roads, sewers, piers and other necessities for industrial growth.

But Lessard argues that it may be more costly for society to have plants locate near an existing large centre because new schools, community centres and other necessities and amenities must be put in place to accommodate the expanded population created by the new job opportunities. Coupled with this are increased land costs - not just for the newcomers but for everybody. The land costs and zoning regulations often make it more expensive to build the facilities in large urban centres.

Meanwhile, schools, community centres and other facilities in slow growth centres are underutilized.

He gave as examples of government intervention a federal-provincial project to develop a steel complex in Regina, a joint provincial-federal venture to develop a new industrial park in Cornwall, Ont.; a plywood plant in McAdam, New Brunswick, and another joint project to establish a bleached kraft pulp mill at St. Felicien, Quebec.

Lessard's department has spent more than \$1 billion to have roads, sewers, schools and industrial parks put in place in slow-growth areas to attract industry. Whether history will show that the demographic projections for the year 2000 will in fact become a reality only time will tell.

● HOMES ● TOWN HOUSES



● RENTALS

● CONDOMINIUMS

SEE THE PROFESSIONALS



JON ZORGE REAL ESTATE Inc.

Realtor

877-0155 457-2624



FINN H. POULSTRUP 877-7816
BROKER
JOEY POULSTRUP 877-7858
VI BONNEVILLE 775-6935

REDDOT REALTY LTD.
REALTOR

HAZEL MCBRIDE 877-6404
MIKE ADAMS 877-7071
DONNA ADAMS 877-7071



CHRISTMAS JOY



Binding out with wonderful wishes for the Holiday Season to all of our fine friends and patrons. Thanks so much for doing business with us. It is our pleasure to serve you and we hope to see you soon. May your Christmas holidays be happy and healthy.



(Rear) Ann Peto, Warren Crawford, Audrey Davies, Vicky Lukas

(Centre) Mary Zorge, Jon Zorge, Coring DePaoli

(Front) Sally Reed, Vivian Kausch.

877-0155 457-2624

10 Mountainview Rd. S., Georgetown

CORING DEPAOLI 877-7976 VIVIAN KAUSCH 851-3912
SALLY REED 877-4350 AUDREY DAVIES 877-8357
VICKY LUKAS 877-5476 ANNE PETO 877-9258
WARREN CRAWFORD 877-1491 JON ZORGE 877-5345



BIG TWO STOREY - SMALL PRICE
So far, yet, so close to everything. Four big bright beautiful bedrooms, large one car garage, and room to park your trailer besides. It's a hop and skip from all stores, maintenance free, brick and alum siding. Let's arrange mortgage to suit your down payment. \$64,900. Call 877 0173



WATCH THE SEASONS
Fishing and swimming behind the back fence. Country lot backing onto Credit river, yet located in town. 4 bedrooms, completely renovated, mature home if you want to breathe, you'll like this one. Low, low down payment to suit the lucky Purchaser. \$54,900. Call 877 0173



WINTER WONDERLAND
Elegant split level home on over 1/2 acre in town! Features 2 car garage, family room with log burning fireplace and walkout. Elegant pine kitchen cupboards with built in dishwasher. Many more extras. Call 877 0173 for a look see.



GLAMOUR GALORE
An exquisitely finished custom executive home for only \$72,900. Large formal dining room, eat in kitchen with lots of cupboards space, massive family room with antique fireplace. High quality broadloom throughout. Many extras. A home you can move into by Christmas. \$15,000. down carries for about \$550. P.I.T. Arrange for a change, call 877 0173.



EXECUTIVE SPECIAL
4 bedroom sidesplit in show room condition. 3 baths, large living room, dining room and eat in kitchen, main floor family room, overlooking beautiful ravine lot! Super mortgage, prestige location. Would you believe only \$72,900. A great way to start 1978 by owning this home! Call 877 0173



COUNTRY SETTING
Serene village location. This spacious backsplit in Glen Williams offers deep drilled well, brick and aluminum construction, family room with fireplace, large open kitchen and much more. Call 877 0173



THAT COUNTRY LIVING
This cosy brick and stone bungalow with a large double garage, workshop, and a room for the missus, three bedrooms, large master, entertainment size living room. No smog here, all this for \$79,900. Call 877 0173.



SNOWMOBILE COUNTRY
One mile from Georgetown, make your own trails, large private lot, three bedrooms, large living room 18'x12'. Financing can be arranged. Call before the snow goes. Only \$67,000. Call 877 0173.

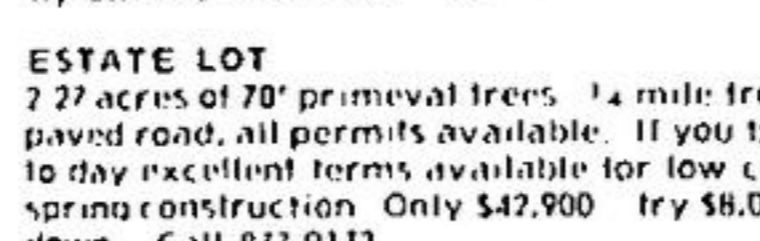

ESTATE LOT
2.27 acres of 70' primeval trees, 1/4 mile from paved road, all permits available. If you buy today excellent terms available for low cost spring construction. Only \$42,900. Try \$8,000 down. Call 877 0173

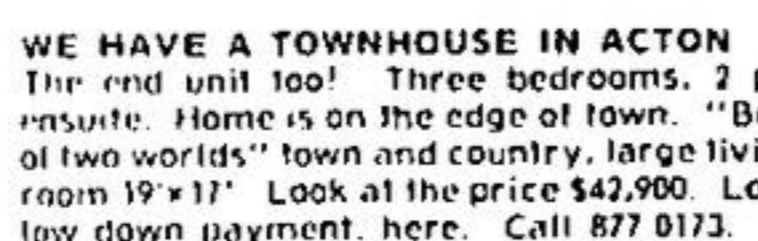

WE HAVE A TOWNHOUSE IN ACTON
The end unit lot! Three bedrooms, 2 pc. ensuite. Home is on the edge of town. "Best of two worlds" town and country, large living room 19'x11'. Look at the price \$42,900. Low, low down payment, here. Call 877 0173.

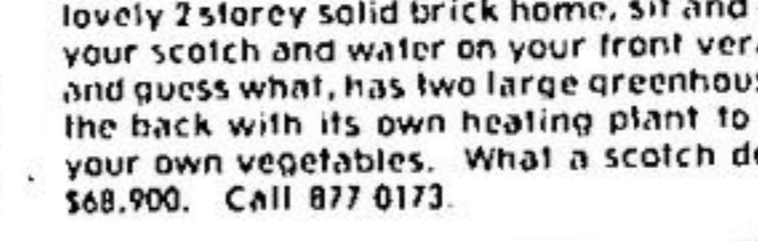

YEE OLDE "BONNIE DOON"
Get yee pennies out of your purse lad, for this lovely 2 storey solid brick home, sit and drink your scotch and water on your front veranda, and guess what, has two large greenhouses at the back with its own heating plant to grow your own vegetables. What a scotch deal at \$68,900. Call 877 0173.



MAIN STREET
Prime commercial location with over 1700 sq. ft. of ground floor space - plus full basement and upstairs apartment which can be easily duplicated. Owner will lease back 800 sq. ft. allowing 2 store fronts. Only \$10,000, to 1 mortgage. Call 877 0173.



Canada Trust

877-9500

W. F. HUNTER REAL ESTATE

& INSURANCE LIMITED
122 Guelph St., Georgetown



A CHRISTMAS WISH: We hope you enjoy a happy holiday season in warmth and peace. Our best wishes of the season to everyone.



TERRA COTTA

On Credit River - Located in Terra Cotta, the property is 130x165 ft. deep and is a truly beautiful well treed lot. The large home is 2 storey stucco that requires renovation and remodelling. The price is what you would normally expect to pay for the land only. Asking \$50,000.

NORVAL AREA

3/4 acre in Norval area, 125'x250', well treed. Ideal location for a prestige home.

CALEDON - 17 ACRES

What seclusion this well treed 17 acres offers - with over 1000 ft. frontage and great possibilities for large lake - a very unusual piece of property - interested? Call and we'll show it to you.

OFFICE 877-4441 OR 877-5165

KATHLYN BURNS 877-6741
IRENE CURRY 877-6616 LLOYD CRICHTON
MARJ HUNTER 877-6906
HUGH HUNTER A.A.C.I.
APPRAISAL MANAGER 877-1931

WM. M. WATSON F.R.I. MANAGER
29 MAIN ST. S.
GEORGETOWN ONTARIO
TORONTO LINE 452 2900

ASK ABOUT OUR BRIDGE LOAN PLAN

