

**SOLD**

THE SIGN OF PERFORMANCE



Ev Patterson with this week's mortgage rates. The mortgage rates quoted below are prime rates and are available to qualified customers on top quality homes in good locations.

Term 1 yr. 2 yr. 3 yr. 4 yr. 5 yr.  
Rate 10% 11 11% 12% 12%

**247 Guelph St.  
Georgetown**

**877-5165**

# THIS WEEK'S AFFORDABLE HOMES



**FOR THE EXECUTIVE**—the elegant 3 bdrm. home offers—2 fireplaces, family rm., 2 w/o sun decks, in-ground pool, stream, trees, one acre in Georgetown country setting. Min. to Go Train, \$138,900. Call Herb Spitzer 877-5165. 83-229



**BRAMPTON-DET.** 4 BDRM., 2 STOREY 2 baths, rec. rm. central air, all appliances bar, pool table, shows very nicely plus a large fenced lot. Asking \$75,000 plus land lease. Ask for Audrey Davies. 84-265



**EXECUTIVE APPEAL!** Near Georgetown. Immaculate. 7 ac. Est. Secluded in trees w/rustic rail fencing. Includes brick & alum. 2 sty., w/7 rms., heated in-ground pool, hipped roof barn, roofed kennel w/livence. Call Harry Burt. 83-232



**GET READY FOR SPRING!** Hillsburgh building lot—165x170 backs onto farmland, fresh spring on property. With \$7,500 down assume the existing mtg. Start building in Spring. Call Ursula Zeldler. 83-169



**PRIVACY & LOCATION** Exec. 5 bdrm. rancher on 10.5 rolling acres. Many features, pond site, 2 FP's., 4 baths, 3 walkouts and much more. Asking \$229,000. Ask for Audrey Davies. 83-200

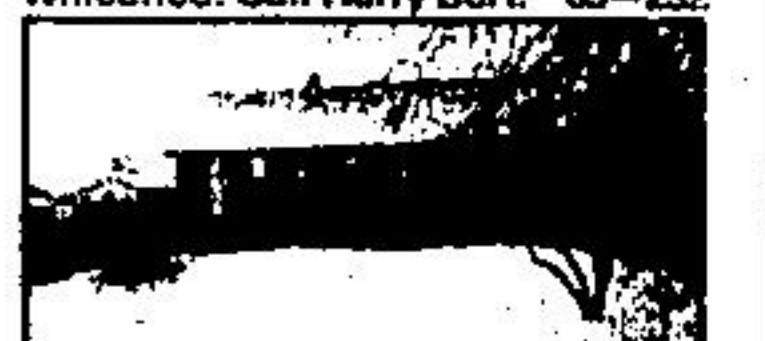

**NEW LISTING** Nearly 1/2 acre private treed lot, 3 bdrm. brick bungalow, garage, New kitchen and bath. Shows extremely well. Asking \$83,900. Ask for Audrey Davies. 83-262



**REDUCED—\$73,900 ASKING!** 3 bdrm. home w/new kit., new bathrm., new windows, fin. fam. rm. w/bar, safe fenced yd. in great location. Call Brenda 877-5165 or 877-7578. 83-240



**ERIN TOWNSHIP** Building lot 3.1 acres, just North of Highway No. 7, driveway in, tree lined at front, 1/2 clear, 1/2 bush, with creek running alongside property. \$42,900. Call Ursula Zeldler 83-191



**FARM NEAR ERIN** Slightly rolling 100 acs. Loam all workable, Vict. brick home 8 rms. Bank barn suitable for horses. On hardtop. Asking \$199,000. Call Harry Burt. 83-249



**CUTE AS A BUTTON.** 3 bdrm. bungalow, 2 down, 4 pc. bath, rec. room, built in bar, garage, treed lot. Only \$55,900. Call Herb Spitzer 877-5165. 84-266



**\$75,900, 3 BDRM. HOME ON LARGE FENCED LOT** Family room with cozy fireplace and bar. For inspection call Alice Pokluda. 83-181



**COZY 3 BEDROOM BUNGALOW ON A QUIET** Street backing onto conservation. Fin. R.R. with Franklin fireplace. \$64,900. Call Diana Arnold. 83-242

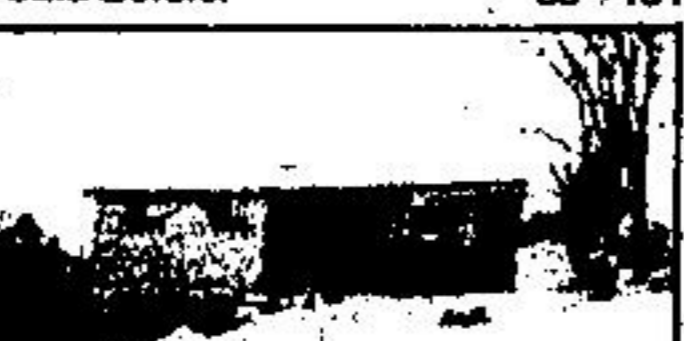

**NEW LISTING—SPACIOUS 3 bdrm.** Brick & Alum. Near Go. Private yard, finished fam. rm., 2 baths. Asking \$81,900. Call Brenda Payton 877-5165 or 877-7578. 83-264



**BRAND NEW CUSTOM SEMI-DET. BUNGALOWS** Fantastic full basements. Extra large lot, parklike setting. From \$62,900. Call Diana Arnold 877-5165. 83-153



**POST VICTORIAN RED DOUBLE BRICK 3 bdrm.** home in great location near park, shopping & Go Service. Asking \$84,900. Ask for Brenda 877-5165 or 877-7578. 83-237



**BRAMALEA** Detached 3 bdrm. home on a large landscaped lot, with in-ground pool. House and grounds show to perfection. Ask for Audrey Davies. 83-254



**REDUCED—CENTURY STONE HOME** on a gorgeous acre, treed lot, barn at rear, stone F.P. in living rm. Now asking \$99,500. Ask for Audrey Davies. 83-218

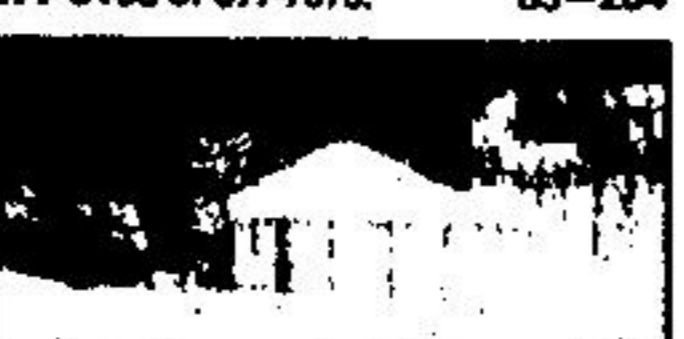

**PRESTIGE LOCATION** on Forks of the Credit Rd. 80 x 140 lot, small cabin, well, hydro, trees, building permit. Don't miss it at \$69,900. Call Herb Spitzer 877-5165. 83-262



**LITTLE RANCH ON 3 ACRES NORTH** of Georgetown, main floor family room with fireplace and walk out. Asking \$122,000. Call Bette Stokes. 83-250



**BEAUTIFULLY RESTORED OLDER HOME ON THE Main St.** in Erin. 4 bdrm., main fl. fam. rm., 2 baths. Zoned commercial. Asking \$86,900. Call Diana. 83-222



**REDUCED \$77,900—Lovely 3 bdrm.** bungalow, eat-in country kitchen, large R.R. with airtight stove. Many extras. Call Ev Patterson. 83-245



**THREE FOR THE PRICE OF ONE.** 3 bdrm. home, walk-out basement, body & paint shop, 2 storey older barn, great for antiques. Priced below market value at \$84,900. Call Herb Spitzer 877-5165. 84-269



**SMALL FARM,** South of town with 5 acres hardwood bush, barn, for horses or cattle. Original farmhouse, 36 acres, gently rolling. Call Bette Stokes. 83-122



**UPGRADED BROADLOOM THRUOUT** Fridge and stove included. Shows very nicely. Asking \$44,900. Ask for Audrey Davies. 83-252



**CUSTOM BUILT—2 storey, 4 bdrm.** Large private lot with in-ground pool close to all amenities. Call Ev Patterson. 83-164



**2 OR 3 BEDROOM MOBILE HOME** & Fam. room, fridge, stove & draperies, included. Call John Kroezen 877-5165. 84-271

**FARM HOUSE—RENTAL** North West of Hillsburgh. \$650 per month. Plus heat and hydro. Minimum 1 year lease. References required. 4 bdrm., L.R., dining rm., large kitchen, 8 acres. Call Ursula Zeldler for more details and directions. 83-252

**225 ACRES,** Trees, Streams, Pond, hills at \$1,100 per acre. Call Herb Spitzer 877-5165.

**FOR RENT** Large 4 bdrm. farmhouse for rent, 5 min. north of Georgetown. \$350 per month. Ask for Audrey Davies.

**2000 SQ. FT. HOME** w/cozy main fl. family room, formal dining room and large eat-in kitchen. Extra large fenced yard. Asking \$125,700. Call Alice Pokluda. 83-226

**ONLY LOCAL ANSWER SERVICE** Large established clientele, for information. Call Ev Patterson. 83-187

**2 1/2 ACRES—JUST NORTH OF GEORGETOWN** Overlooking two ponds, ready for your dream home. \$89,900. Call Herb Spitzer 877-5165.

We have many other exciting homes from which to choose. Our agents would be happy to provide you with the details. Please call.

- |                         |                         |                         |                        |                            |                            |
|-------------------------|-------------------------|-------------------------|------------------------|----------------------------|----------------------------|
| Nancy Kohnen 877-4422   | Wilma Marshall 877-8287 | Harry Burt 518-868-4578 | Audrey Davies 877-8357 | Herb Spitzer 877-8855      | Brenda Payton 877-7578     |
| John Kroezen 877-2722   | Cathy Perogo 877-9438   | Lorraine Riley 877-3927 | Olga Fedun 877-5718    | Ev Patterson 877-8886      | Ev Patterson 877-8886      |
| Sharon Piskney 877-8578 | Pat Hammer 877-3648     |                         | Bette Stokes 877-4682  | Diane Arnold 819-833-2128  | Diane Arnold 819-833-2128  |
| Karen Fishbein 877-8883 | Murray Smith 863-8315   |                         | Alice Pokluda 877-8388 | Dave French, Mgr. 467-8787 | Dave French, Mgr. 467-8787 |