

Environment Canada releases regulations

The 1978 Migratory Birds Regulations for Ontario have been released by the Canadian Wildlife Service, Environment Canada.

Season dates are only slightly altered from last year. Bag and possession limits remain the same except that in Southern District II, two Canada geese may be harvested daily.

The season on geese remains closed in portions of Mono Township in Dufferin County, portions of Camden East Township in Lennox and Addington County, portions of Norfolk Township in the regional municipality of Haldimand-Norfolk, and in the Wye March Wildlife Management Area in Tay Township, Simcoe County.

Once again, there is no open season on migratory game birds in that part of the township of Norfolk known as the Big Creek National Wildlife Area or in portions of the township of Dover West, Kent County.

All hunters except Indians and Inuit require a migratory game bird hunting permit. This is sold for \$3.50 at post offices throughout the province. Post offices also display posters outlining the migratory birds regulations and distribute abstracts of these regulations. Hunters are advised to buy their permits early this year.

The Canadian Wildlife Service asks hunters to keep careful records of their daily bag on the card attached to the permit. This information will help hunters complete the harvest survey questionnaire to set bag and possession limits and season dates for next year. The 1977 harvest survey indicated that 157,000 licensed Ontario hunters bagged 913,000 ducks and 67,000 geese.

Silage gas kills

Agricultural safety experts in Ontario are concerned that silage gas could be a lethal problem again this fall. Three farm workers near Gananoque were killed as a result of exposure to this highly toxic gas in 1977.

Jim Ross, Senior Safety Consultant for the Provincial Farm Safety Association, says that a large variation in climate during this growing season may have placed enough stress on the corn crop to allow it to produce silage gas once the plant material is put into the silo.

Mr. Ross advises farmers that crops should be mature before they are cut, also that harvesting should be avoided immediately after a rainfall.

Silage gas may be recognizable as a yellowish-brown gas with a bleach-like odor. It can form within hours of filling a silo. The Association advises farmers that the problem with the gas is that it may be present for two to three weeks, once the silo is filled.

The Association advises farmers to keep everyone away from the silo once it is filled. If for any reason it is necessary to enter the silo during the two to three week danger period, a self-contained breathing apparatus must be worn.



Saxe

Stephen P. Saxe Limited Realtor

877-2219 or 453-1111 TORONTO LINE



HIGH ON A HILL COUNTRY COMFORT

\$168,000

RECREATION & PRESTIGE!

3 Acres North west of Georgetown with a 280 degree view of rolling pasture land. The house has everything to make it comfortable in winter, spring, summer or fall so all you have to do is call John Caton and I'll be there, to show you your future home.

COMMERCIAL STORES
4000 sq. ft. \$1650 per month
900 sq. ft. \$375 per month
900 sq. ft. \$375 per month
1500 sq. ft. \$113 per month
All properties net.
Call Tom Cooper or Eleanor Langdon.

BUY YOUR OWN GARAGE!
3 bays, Shell gas pumps, all equipment included, paved lot good outside storage, office, income from apartment. Located in Georgetown. Asking \$135,000.00. Call Tom Cooper or Rozetta Stolp.

GOOD OPPORTUNITY IN RURAL AREA

73 Acres of land with bank barn, approximately 40 acres of good workable land, balance is mostly cedars with pond sites. An ideal location for your hobby farm just 20 minutes from Georgetown and close to paved road. Asking \$87,500. Call Norm Sinclair.



\$56,900—DUPLEX SPECIAL

This 2 storey brick home has 2 self-contained apartments and has recently been improved with a roof, wiring, aluminum soffits, fascia and eaves. Centrally located to schools, shopping and all amenities. For your exclusive viewing call John Caton.

TALL PINE ESTATES

Don't miss it. Exclusive park area with very unique homes. Right now 1 home open for inspection. Exceptional "curb appeal" as well as host of well-thought-out interior amenities. Note the outstanding workmanship. Drive by tonight or better still call Robin Fischer or Eleanor Langdon to tell you more about them.

These homes are sold. Only 2 lots left to choose from to move in before Christmas! Come and see the plans.

Lot 12—\$109,800—4 bedroom 2060 sq. ft., walkout basement, ground floor laundry. Dormer roof-line.

Lot 11—\$106,800—4 bedroom side split. 2-4 pc. washrooms. Contemporary design.

Lot 6—\$105,800—3 bedroom side split. Walkout family room. No crawl space. Double car garage.



COUNTRY SIDE SPLIT 1 MILE FROM TOWN

This 3 bedroom split level has a unique lay-out, great for entertaining. The dining room and kitchen are on one level with a walk-out to a huge back yard. Just minutes from town but quiet country living. Priced at \$108,500. Call Robin Fischer for an appointment.

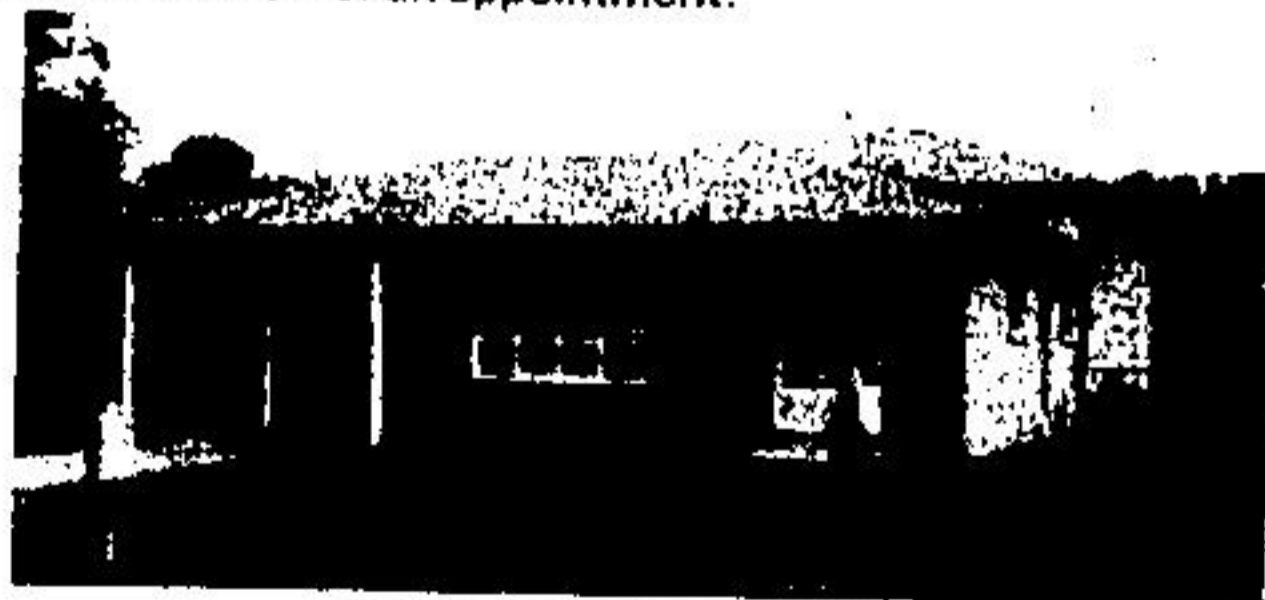

PRICE REDUCED \$59,900 BACKSPLIT—NEAR GO TRAIN

3 bedrooms, living, dining room, eat-in kitchen. View family room from kitchen for easy supervision of children. Carport. Call Coring DePaoli.

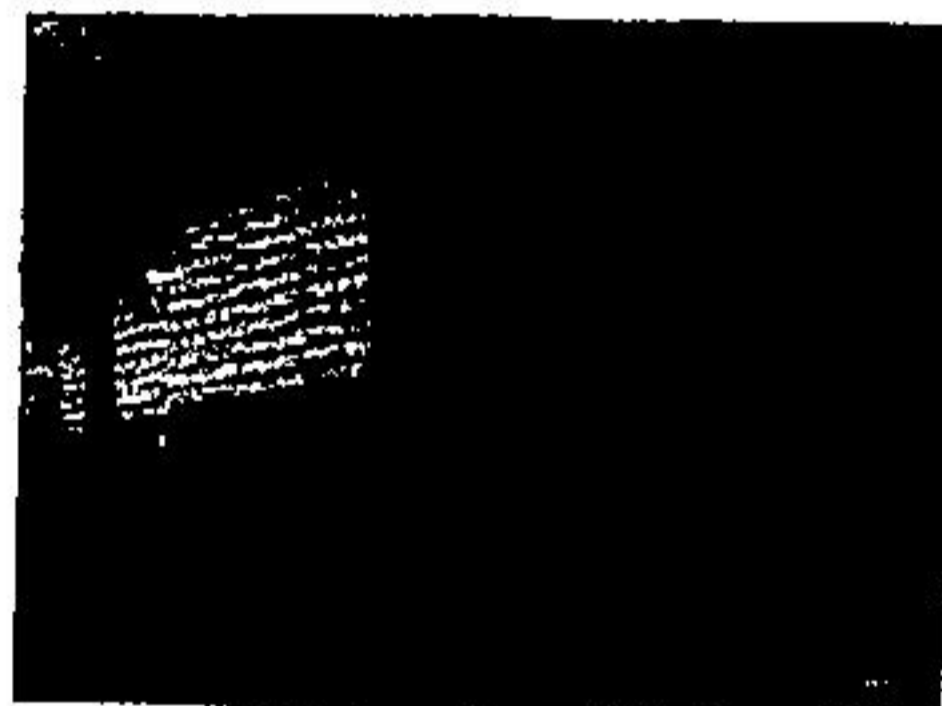

EXCELLENT STARTER

A fenced yard for the kids, central air conditioning to beat the heat, deck, living room, dining room and eat-in kitchen. Three good sized bedrooms upstairs in this semi. Priced at \$59,900. Call Eleanor Langdon.



WOULD YOU LIKE A MAIN FLOOR FAMILY ROOM AND PAY ONLY \$49,900?

Then find out more about this home. It is not only amazingly spacious and very clean but has 3 bedrooms, living and dining room, eat-in kitchen, 2 bathrooms and garage. Too good to pass by. Call Rozetta Stolp.

Stephen P. Saxe Limited, Realtor
170 Guelph Street, Georgetown, Ontario

Tom Cooper, F.R.I. 877-9620
John Caton 877-6564
Norm Sinclair 877-6050

Robin Fischer 877-7194
Eleanor Langdon 877-2493
Howard Caton 838-2708

Coring DePaoli 877-7976
Rozetta Stolp 877-2180
Don McMillan 854-2435
Wendy Saxe 877-2984