

# Practical & Decorative Values For The Home Or Cottage

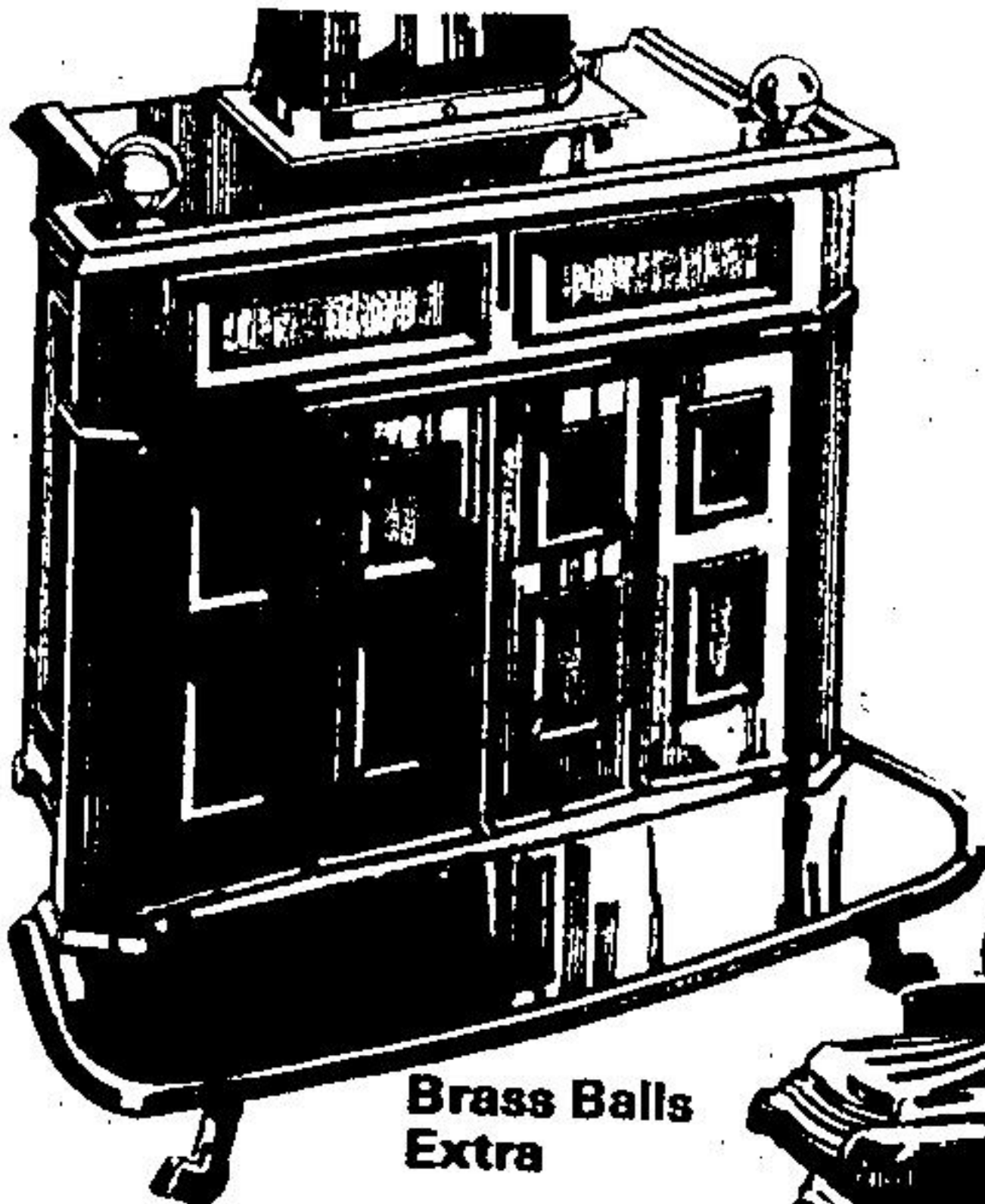

Brass Balls Extra

## Franklin Stove

Traditional styling and modern efficiency highlight the Franklin. The all cast iron body give it authenticity and the look of yesteryear. Can be enjoyed as an open fire or as a heater when the doors are closed. Vents to rear or through top.

**199<sup>99</sup>** Our Reg. 219.99  
Grate & Boot  
30" Opening

**149<sup>99</sup>** Our Reg. 179.99  
26" Opening



Save \$10

## Rectangular Shaped Box Stove

Super rugged construction in cast iron. Burns coal or wood. Has a large feed door & bulging sides for increased capacity. Swing top and 6" cover plates. 23" high, 30" long and 12" wide.

**79<sup>99</sup>**

Our Reg. 89.99

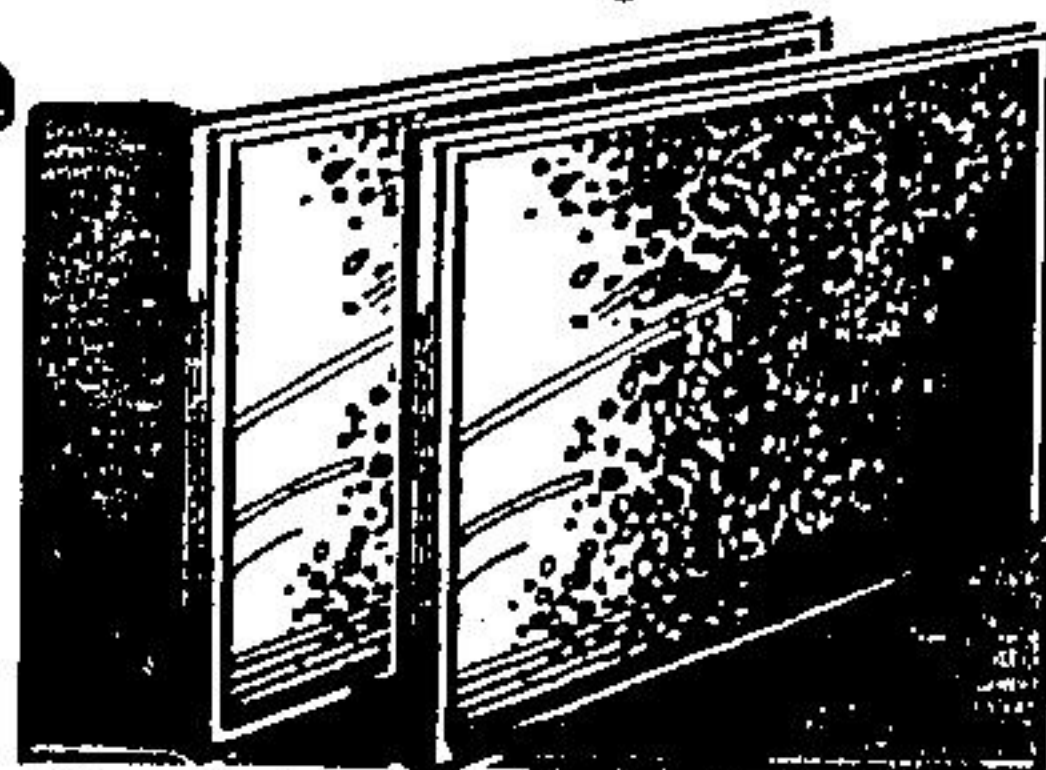

## Cork Bulletin Board

Light cork bulleting board with wood frame. 3/4" thick board. Cork Tiles (self stick back) 12" x 12" x 3/8".

**2<sup>99</sup>** 12" x 18" **6<sup>99</sup>** 24" x 36" **1<sup>99</sup>** Pkg. Cork Tiles

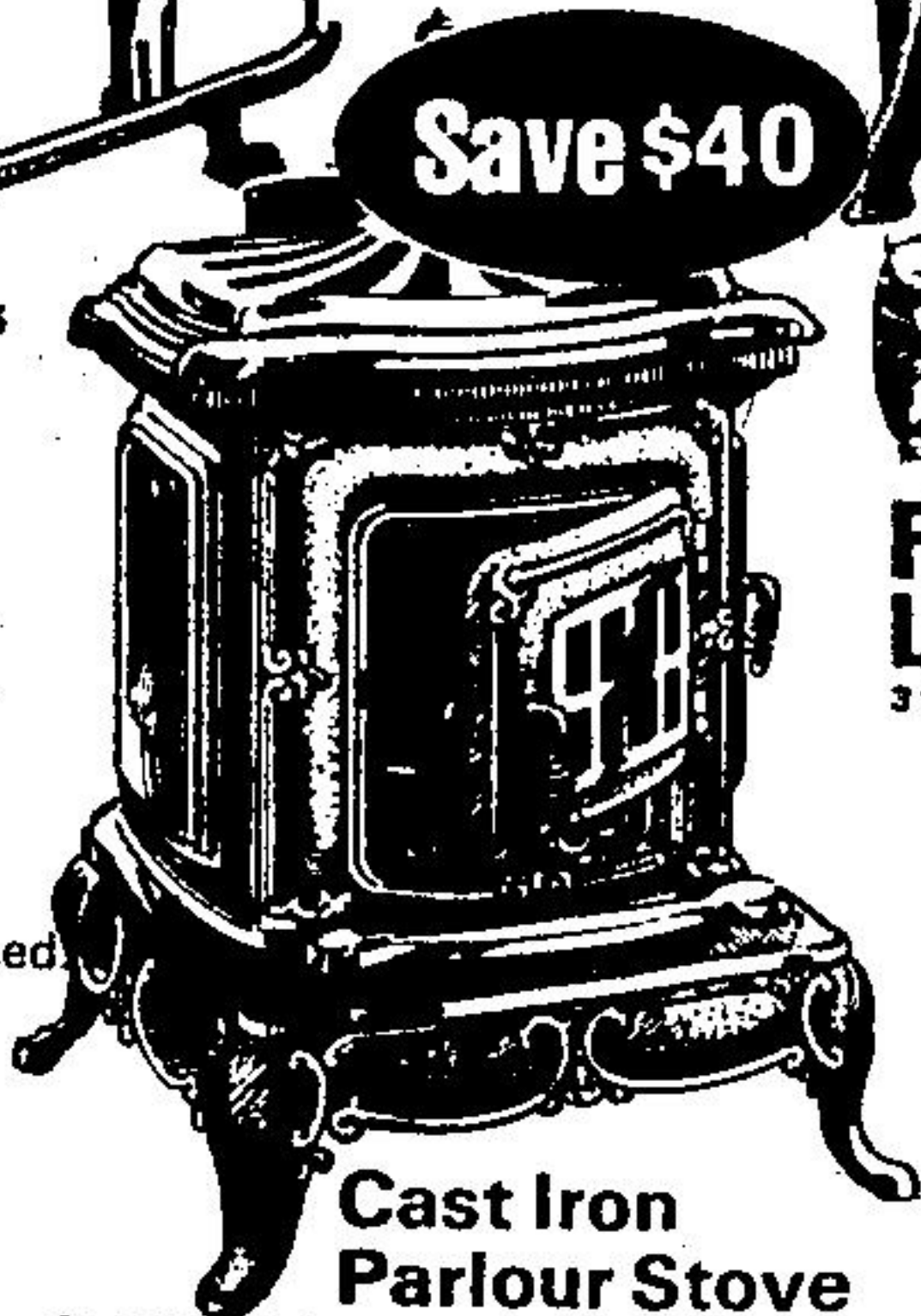

Save \$40

Fire Log **79<sup>c</sup>**  
3 1/2 lbs.

## Cast Iron Parlour Stove

Flat Black finish accented with nickle window frame. Includes nickle foot rail, top rail & swing top. Two cooking plates. Burns coal or wood. 31" H.

**149<sup>88</sup>** Our Reg. 189.99

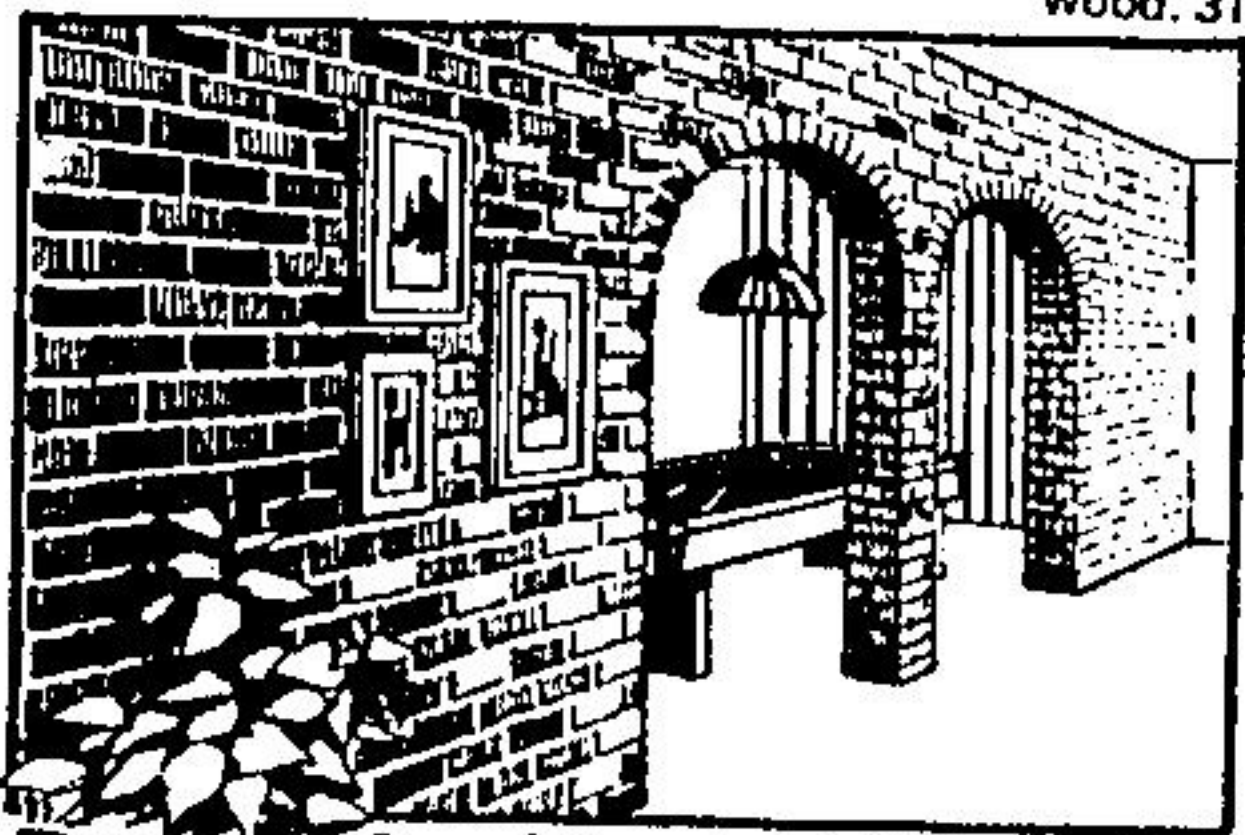

## Decorative Flexi-Brick

A super idea for the rec room or den. Flexi-brick is easy to put up and very economical. It gives the look of real brick in a variety of colours. Covers 5 sq. ft.

**4<sup>99</sup>** Antique Red  
**6<sup>99</sup>** Old Colonial Red  
Provincial Used

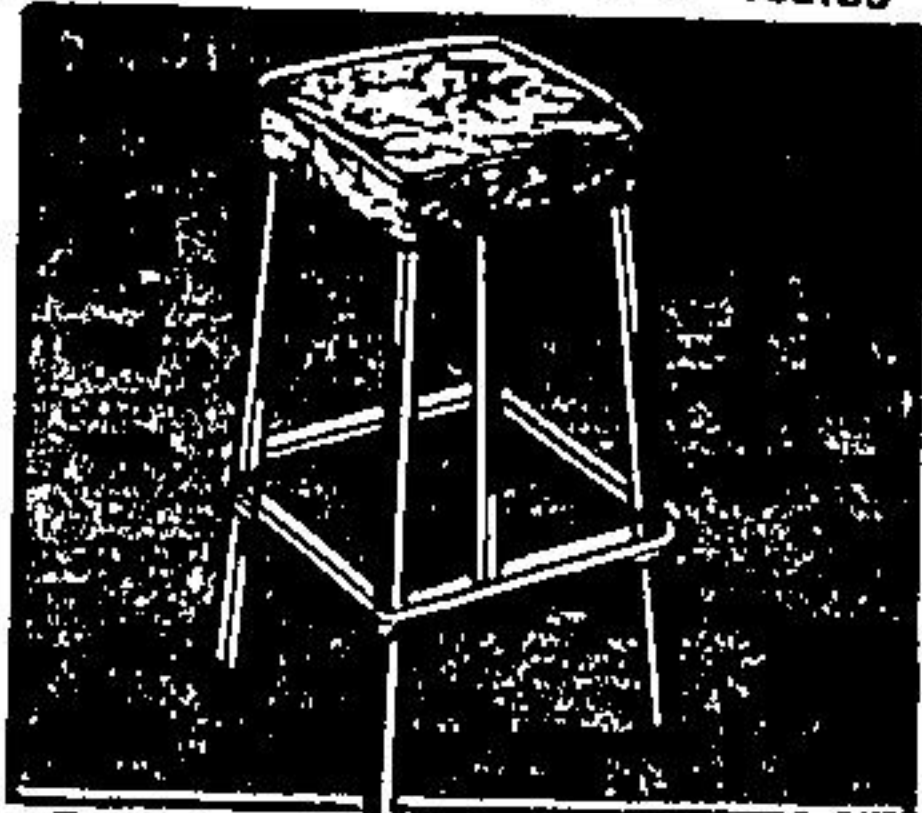

## Square Bar Stool

Attractive Sand Ranchyde vinyl covering matches Sand Ranchyde bar. Chrome legs and tubing.

**26<sup>99</sup>** Our Reg. 29.99

