



Winning Team

(519) 853-2086

Toll Free 1-888-833-1945 E-mail: jgarel@trebnet.com
RE/MAX BLUE SPRINGS REALTY (Halton) CORP.

**Associate Broker *Sales Representative



Dave Braida*



COMMERCIAL INCOME PROPERTY

Office and apartments. Freestanding building with main floor office/retail, main floor 1 bedroom apartment & upstairs two + bedroom apartment. Updated gas boiler heat. Good state of repair. Asking \$179,900. Call Dave Braida* for all the details.



ORIGINAL VICTORIAN CHARACTER - \$169,900

Wide trim, high ceilings, French doors, etc. Separate this home from the newer homes built today. Wraparound porch, plaster walls, potential for second floor apartment. Located in a highly visible area of Acton. Call Dave* or Janis** for details.



YOUNG FAMILY REQUIRED

Nearly brand new, Chickadee model. Thousands in upgrades, 2 full baths, ceramics, Oak kitchen and more. Call Janis** or Dave*. 853-2086. Only \$205,000.



HOME SWEET HOME...

Says it all. 3 spacious bedrooms, plus 4th in the bright basement with above grade windows. Eat-in kitchen plus combo living/dining room with walkout to deck overlooking treed backyard. 3 washrooms and main floor laundry. Look no further at \$179,900.00 it's a steal. Call Janis** or Dave* 853-2086.



IN-LAW POTENTIAL

Bungalow in Burlington. Nice mature area. Oak kitchen, updated bathroom. Full basement plus rec room. Only \$189,900. Call Janis** for details.



BOVIS BEAUTY

Well maintained by original owners. Renovations include Oak kitchen and 2 bathrooms. Oversized double garage. Upgraded broadloom. CAIR/CVAC and more. Asking \$229,900. Call Janis** or Dave*.



IT'S PERFECT!

Spacious 3 bedroom townhouse. Gas furnace, central air. Clean as a whistle. Private driveway. Asking \$129,900. Call Janis** or Dave*. 853-2086.



\$179,900.

TO BE BUILT

Two semi-detached homes in downtown Acton by Quality Custom Builder. Walk to shopping and church. Pick your own options & colours. \$179,900. Call Dave* or Janis**.



DEVELOPMENT POTENTIAL

Excellent opportunity for development. 116.3 acres with highway #7 frontage between Acton & Georgetown. Call Dave* for more information. \$699,000.



\$84,900.

10 ACRES

Erin Township residential building parcel. Road in, partially fenced & small shed on property.



Vacant Land

IN TOWN RESIDENTIAL BUILDING LOT

Ready to build lot in Acton. All town services available. Central location, close to all amenities. Call Dave* or Janis** for further details.

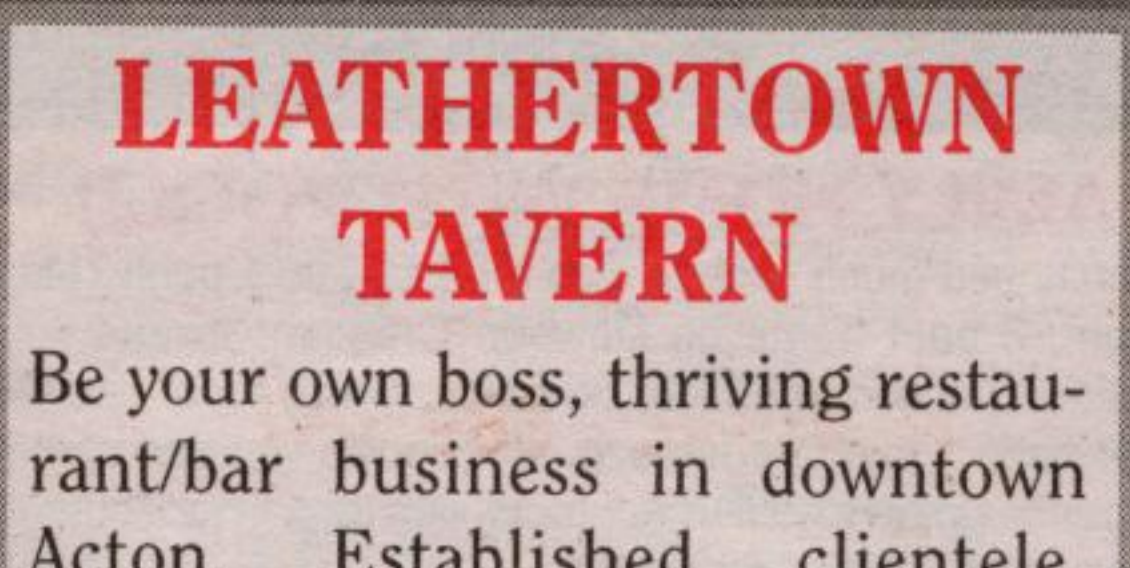

LEATHERTOWN TAVERN

Be your own boss, thriving restaurant/bar business in downtown Acton. Established clientele. Favourable lease arrangements. Includes business and all chattels. Asking only \$79,900. Call Dave* for all the pertinent details.



Town & Country Specialist



Blue Springs Realty (Halton) Corp.

Loc.: (905) 877-5211 Tor.: (905) 874-3051
 1-800-834-5516 Fax: (905) 877-5154

Maureen Plucinsky B.Sc.
 Sales Representative

<http://maureen.ca>



NEW
 Main St Georgetown: Prestigious Park Area. 2000 sq ft home to be built on 66' x 132' treed lot. Walk to all amenities on Old Main St & GO train. \$349,000.



Ballantry in St. George's Glen

Fabulous estate on 2 landscaped ac min from Georgetown & GO. 9' ceilings! Vinyl casement windows. Upgrades galore: stone elevation; 3 car gar; hrdwd; ceramic tiles; open upgraded staircases; upgraded subfloor; pot lights; whirlpool; CAC; CVAC; etc. No trains, hydro towers, planes or traffic. A perfect place to bring up a family. \$479,000



Perfect for socializing

~ 3200 sq ft. Upgraded! 4 bdrm, 4 WRs. Hallmark prof finished bsmt with FP, wet bar, wine cellar & den. Mbdm with FP & sitting area. Greenhouse kit with ceramic floor & walk-out to patio & hot tub. Hardwood flrs. French doors. Coving. Family rm with gas FP & wet bar. Prof landscaped front & rear. Sprinkler & security systems. \$399,900

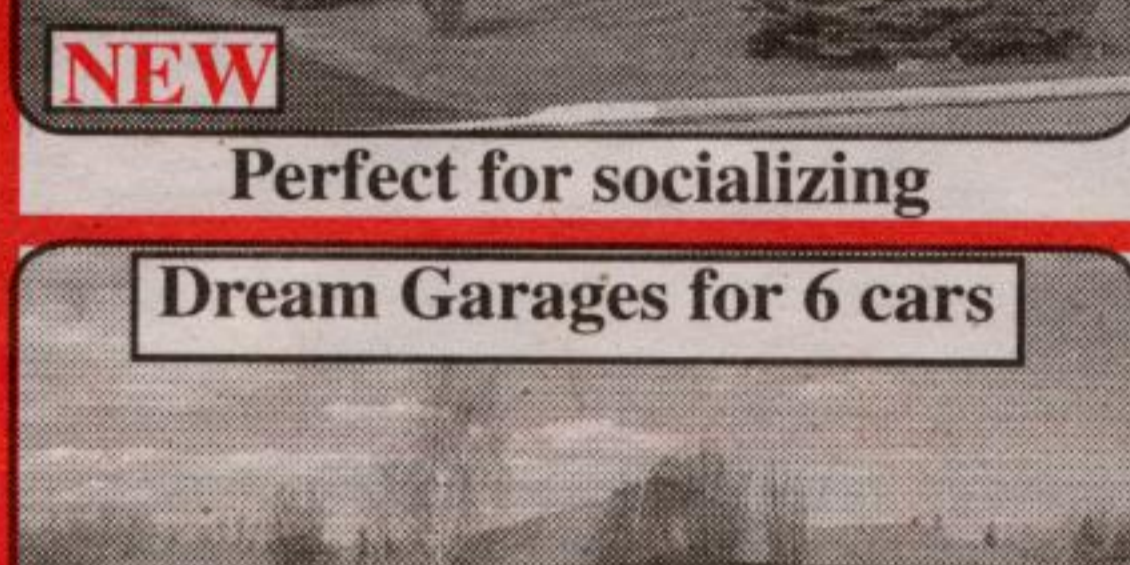

Dream Garages for 6 cars

Milton: Hwy 401 & Trafalgar, South of 5th SR. Open concept with central skylight dome. 9' to 30' ceilings. Huge eat-in kit. Walk-out bright bsmt with high ceilings. 3+2 bdrms. 2 family rms & huge recreation room. 2+2+2 car garage with natural gas. Prof landscaped. Concrete & steel construction. Perfect for home business and/or car collector.



Southcott Dr, ~3 min to 401

North of Rockwood: Fabulous 5.25 ac estate with 2116 x 2 sq ft of living space. Fabulous kitchen with 3/4" maple floor. Family rm with FP & w/o. 3 oak stall horse barn (40' x 24'). 2700 sq ft shop, heated & airconditioned with 2 offices & 2pc washroom. All less than 16 yrs old & built to the highest standards. Trees, stream & 2 ponds with fish! \$459,900



+2700 sq ft SHOP w heat & CAC

South of Hwy 9 & West of Orangeville: 3+2 bdrms, 3 washroom accent stone bungalow. Finished basement. Excellent 6+ stall barn (30'x40') with water & hydro, drive shed (34'x40') & run-in shed. All buildings less than 15 years old. Fenced paddocks. 5ac bush. 2 ponds. 15 ac in hay. ~45 mins to Mohawk. \$339,500. Excellent value.



45 Acre HORSE FARM

Perfect for commuters. Near Ballinafad, minutes to GO train. Land is partly reforested, has 2 ponds & acres suitable for hay at rear. Home, with large principal rms, overlooks a heart shaped pond. The barn, ~6 yrs old, has space for 6 stalls, tack rm & wash rack. Wiring & plumbing are roughed in. Georgetown RR# & tel#. Mail delivered. \$439,000



Erin: ~50 acre hobby horse farm

Mono: 100ac on Hwy 9 with 1000' of tree lined frontage, 5 min E of Orangeville & Hospital. Unique, secluded, elegant home with hrdwd floors. In-law suite with separate entrance. 4 fireplaces. Swim-in pond & stream. ~20 acres in hay. Natural gas on Hwy 9. 1997 survey. No severance taken. Rare string 100 acres. Rolling, treed & clear land. 207445 Hwy 9.



100 ac: Bavarian with character

~95 ACRE FARM WITH 2 HOMES (3bdrm & 5 bdrm) located S of Georgetown, ~10 minutes to 401 at Trafalgar Road. Bank barn with 15 stalls (could -> 40), 5 paddocks, shed & drive shed (80'x40'). Excellent well. Productive, high nutrient, arable soil suitable for many crops. Large pond. Close to GO train & all amenities. Exclusive listing.



10730/2-6th Line Halton Hills



Halton Hills: ~1 acre with 35' x 70' gar + shop w heat & hydro. W of Acton in Crewson's Corner. Backs onto conservation & has a creek. \$259,000.

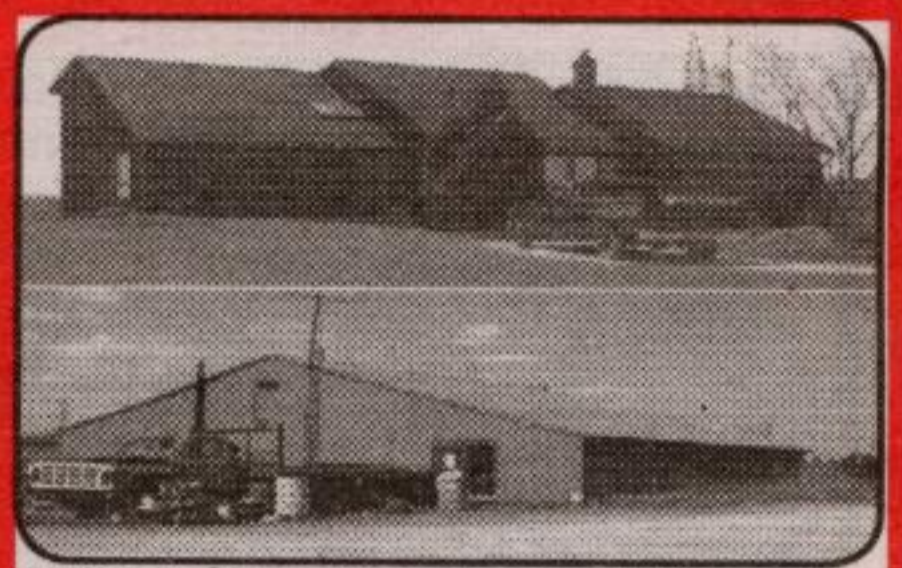

Milton: Investment land. 11.8 ac with 958 ft F on Hwy 25! 4000 sq ft legal, non-conforming industrial steel shop & Viceroy N of Burnhamthorpe. \$1.29M.

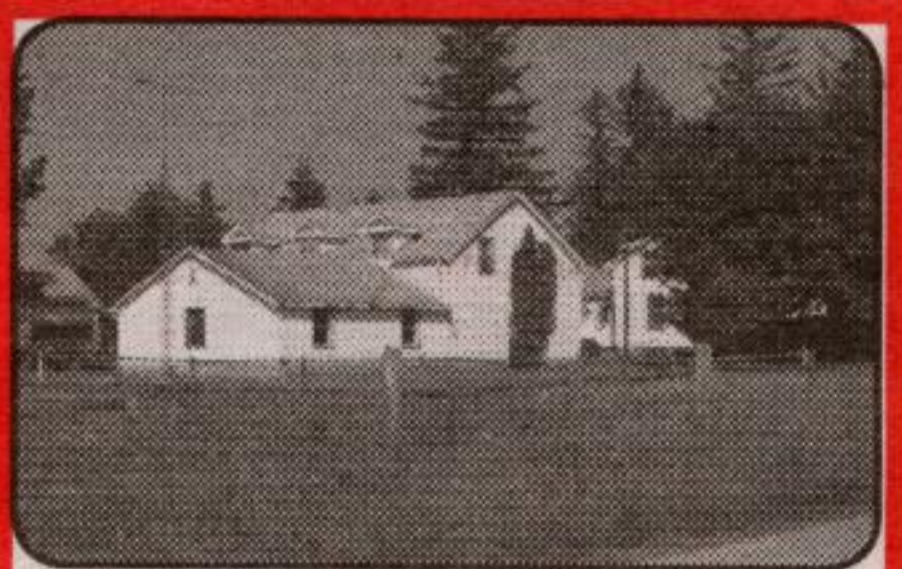

Halton Hills: ~95 ac 2 homes (3bdrm & 5 bdrm) S of Georgetown, ~10 min to 401. Bank barn, 15 stalls, shed & drive shed. Excel well. Pond. 10730/2-6th L.

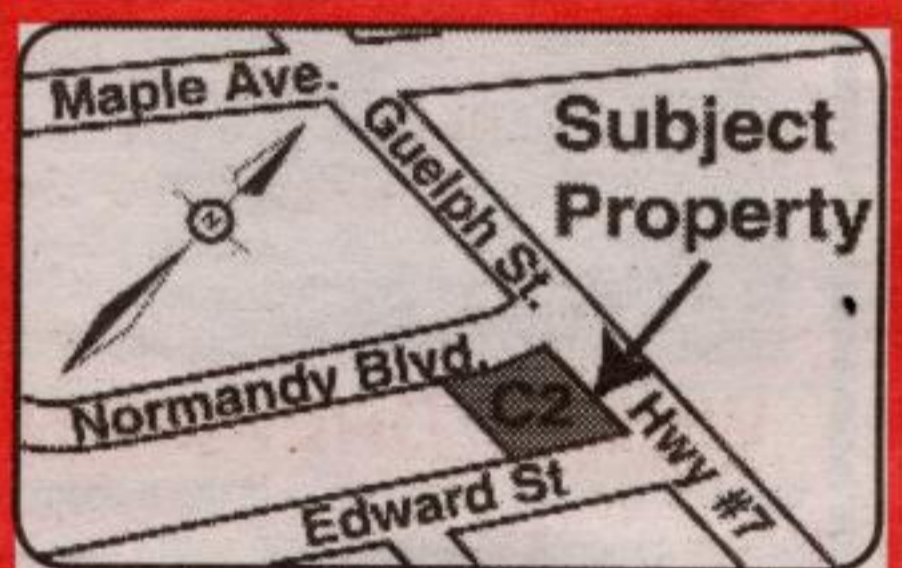

Georgetown: 120-122 Guelph St: brick building, 3 homes, zoned C2, General Commercial. 3 road frontages, perfect for a drive through business. \$650K

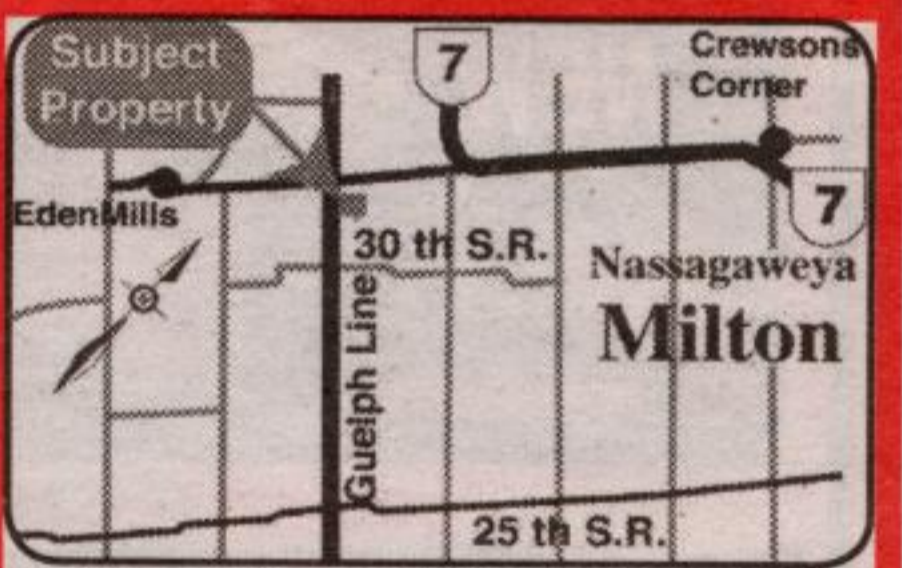

Georgious 8 ac building lot. Suitable for an estate home or hobby farm. Located < 15 min to Hwy #401 at Guelph Line. 512' frontage. \$249,900

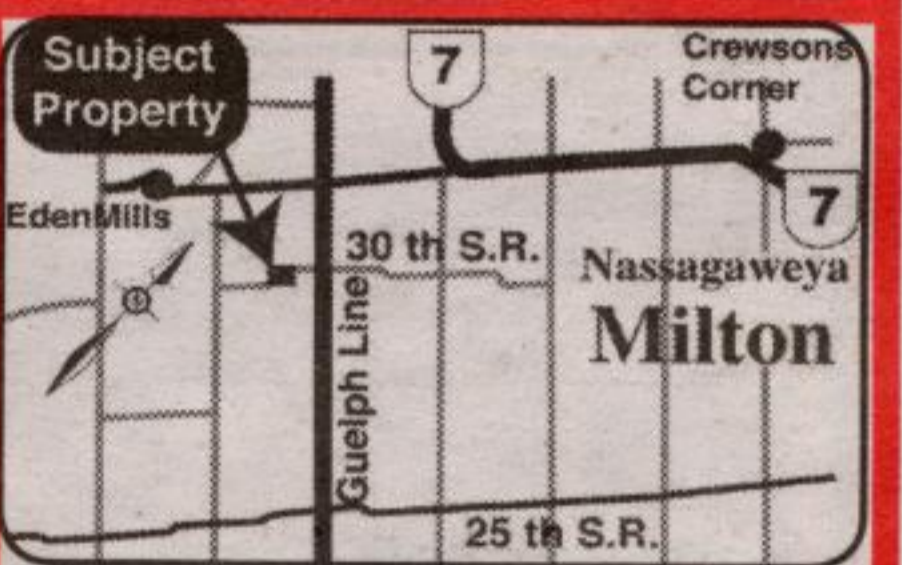

Milton: 2 acre building lot. Located in vicinity of the Blue Springs Creek. Plenty of good water. ~12min to 401 at Guelph Line. Quiet road. \$109,900

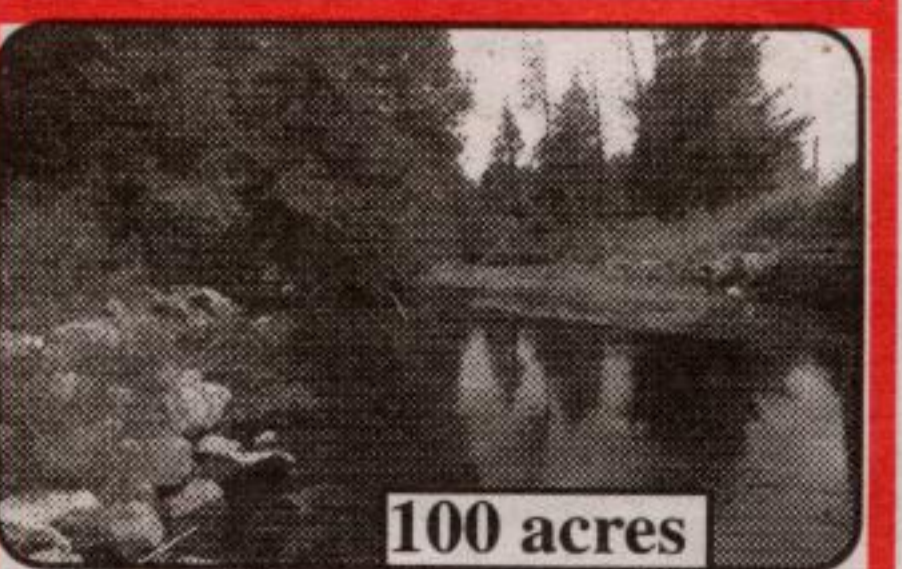

100 acres

Milton: 100 ac. SE corner of 30th SR & 2nd Line. 15 min N of 401. 4200 ft frontage. Creek. 1/2 bush. No railway, hydro towers or traffic. Paved road.

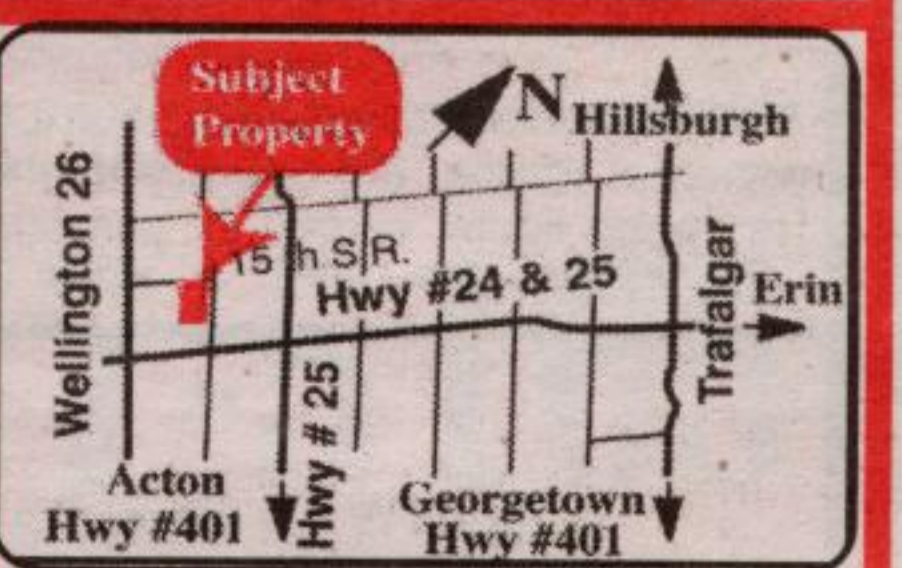

Erin: \$75,000 ~33ac. Vacant land. ~749' F x ~2000' Treed. Jurisdiction of GRCA. W of Erin. N of Ospringe. 1st Line N of Hwy #24 to 15th SR, W.