

4 PIN CROSS ARM 2 WIRES

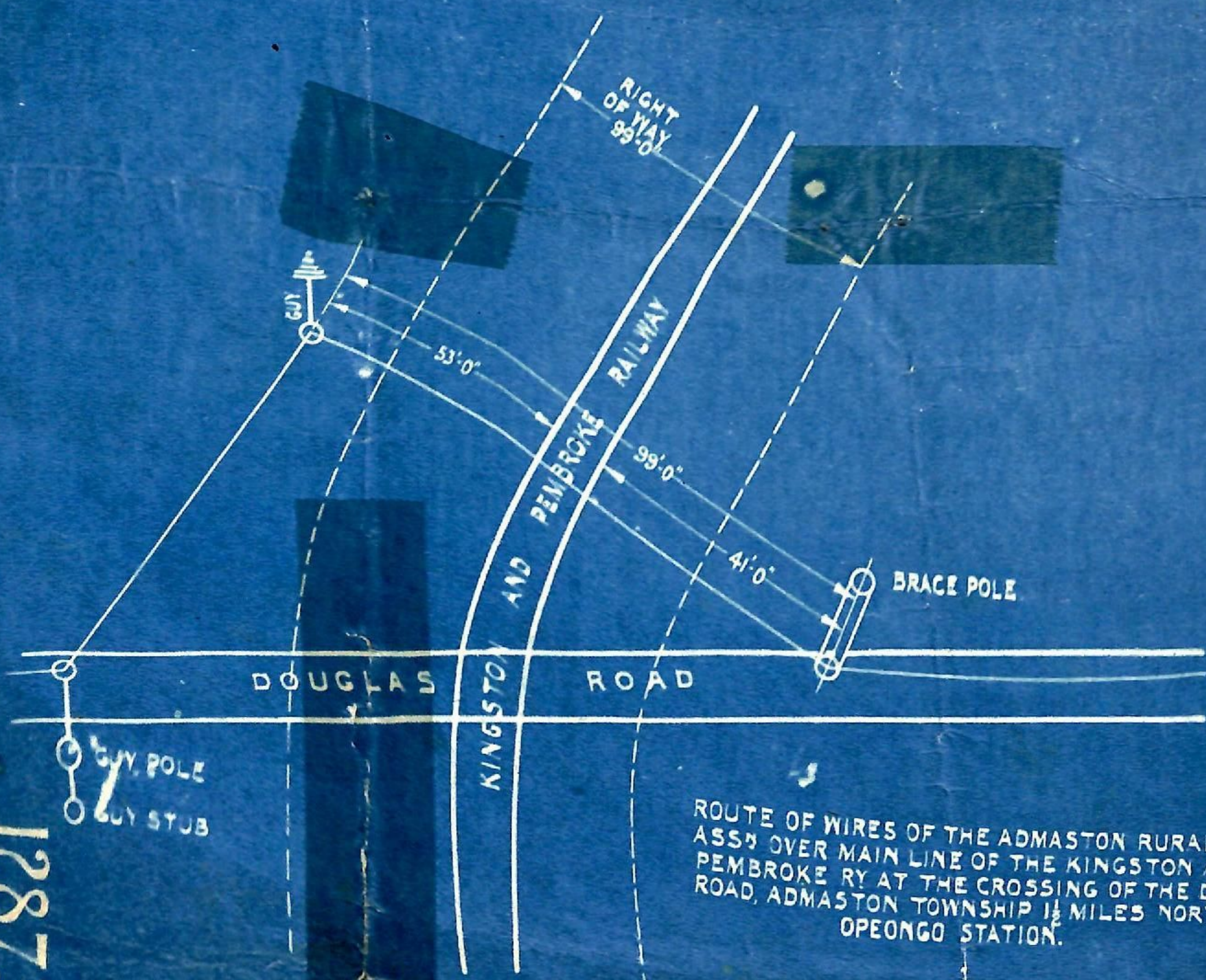
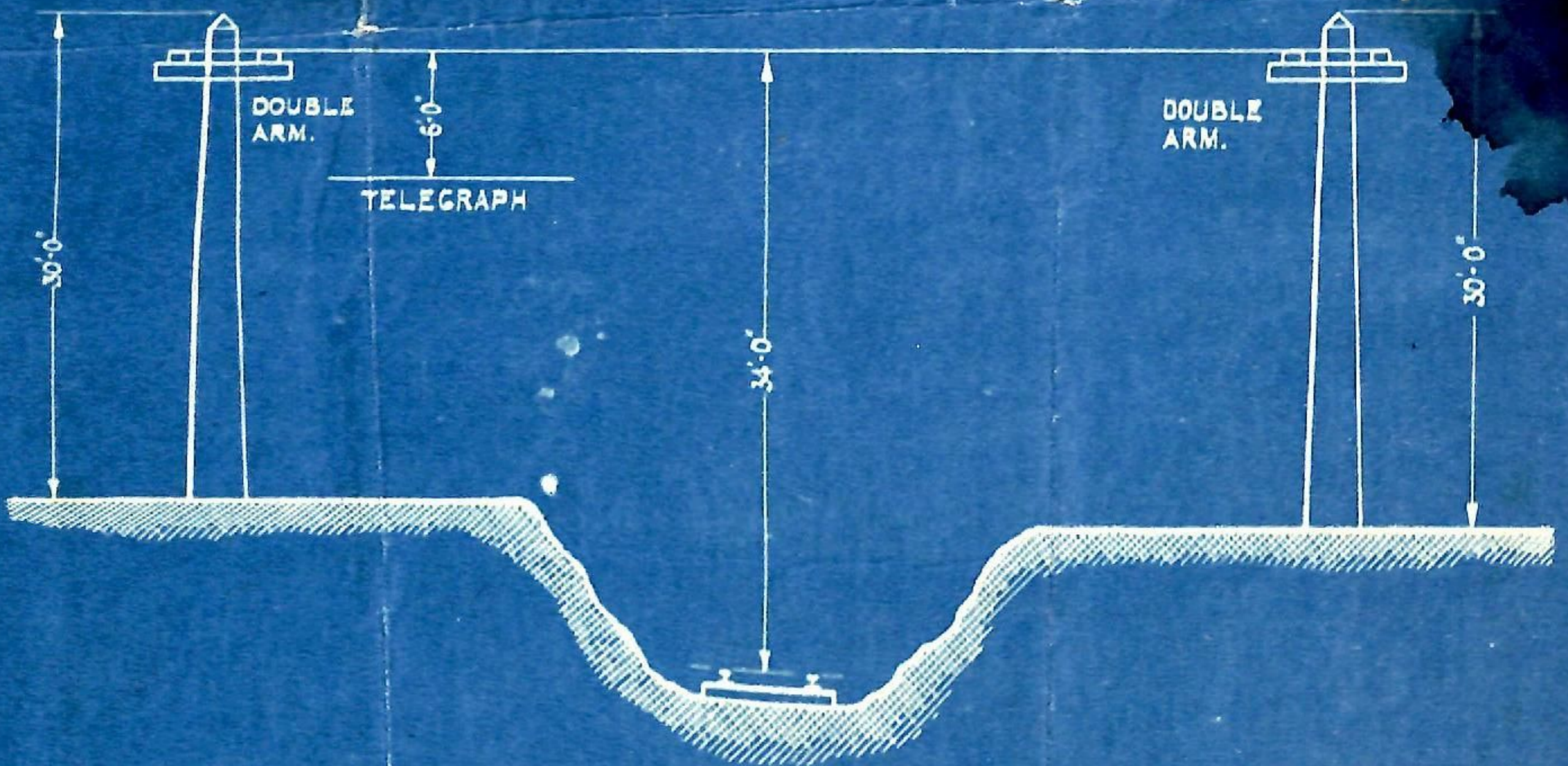

ROUTE OF WIRES OF THE ADMASTON RURAL TEL. ASS<sup>n</sup> OVER MAIN LINE OF THE KINGSTON AND PEMBROKE RY AT THE CROSSING OF THE DOUGLAS ROAD, ADMASTON TOWNSHIP 1 1/2 MILES NORTH OF OPEONGO STATION.

12873

A