

2-5 Area covered by South Saugeen Women's Institute - May 1960.

Showing -  
Highway 21  
Concessions + sideroads  
Farm Lots and  
Present owners.

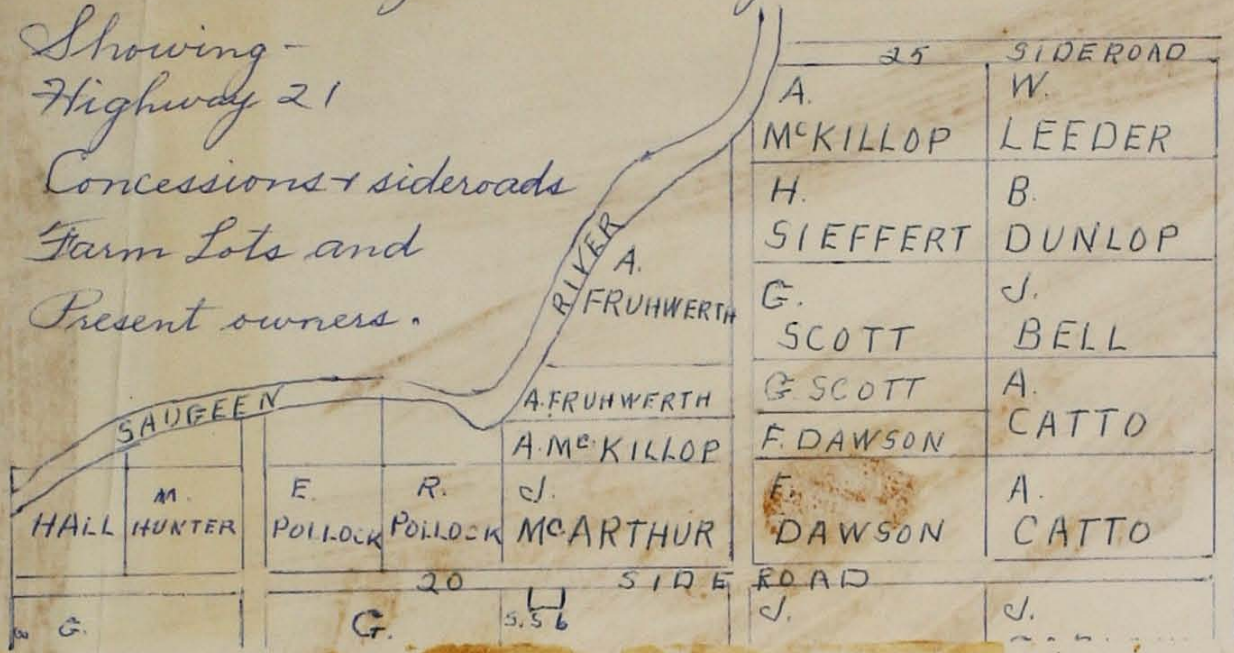

27	A. MCTEER	J. C. McARTHUR	G. POLLOCK	BELL	GARLAND	
26	D. & J. CHRISTIE	TURNERS K. SNYDER D. & J. CHRISTIE	C. McCLINTON R. EBY	G. McCLINTON C. UPSHALL	R. CURRIE R. THOMAS	28 29 HAMMOND
25	M. HAMILTON	D. CHAPPELL	R. EBY	W. SUMPTON	R. THOMAS	21 22 H. PRITCHARD
24	D. CHAPPELL	M. JAMIESON	W. SUMPTON	W. SUMPTON	R. CURRIE	20 C. SCOTT
15 SIDEROAD						
23	A. FINNIE	A. McCULLOCH	K. GOWANLOCK	W. LEEDER	S. RIBEY	19 A. STRUTHERS
22	DOMM	E. McLEAN	G. OSBORNE	C. KELLY D. JEFFREY	C. KELLY	18 A. STRUTHERS
21	R. ZEIGLER E. BUSCH	A. McEWING	G. OSBORNE	D. JEFFREY	C. KELLY	17 A. STRUTHERS
20	J. THOMPSON	R. TURNBULL	R. TURNBULL K. McKINNON	W. DANIELS	J. REOCH	16 D. McEWING
19	R. McRAE	P. JACKMAN	K. McKINNON	J. McEWING	J. McEWING	15 QUEEN HILL CHURCH D. McEWING
10 SIDEROAD						
18	W. TOPHAM	E. McKINNON	G. McCULLOCH	A. SCHWASS	D. LAMONT	C. SCOTT
17	K. LAMONT	I. HAMILTON	G. McCULLOCH D. LAMONT	G. McCULLOCH	R. FENTON	J. BRUNTON
16	N. McDERMID	H. SUTHERLAND	D. LAMONT	A. LAMONT	A. McDOUGALL	E. BROWN
15	E. McLEAN	J. SUTHERLAND H. SUTHERLAND	J. SUTHERLAND	W. SCHILDROTH	N. McDOUGALL	J. BROWN