

MAP OF TERRITORY THE WOMEN'S INSTITUTE COVERS, IN PART
CULROSS, BRUCE ATLAS 1880

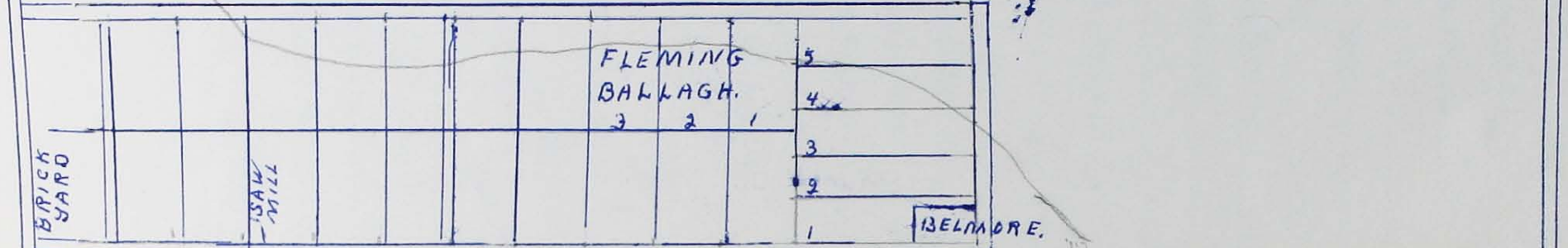

BOUNDARY BETWEEN BRUCE AND HURON COUNTIES AND
CULROSS AND TURNBERRY TOWNSHIPS:

CARRICK TOWNSHIP TAKEN FROM BRUCE ATLAS 1880

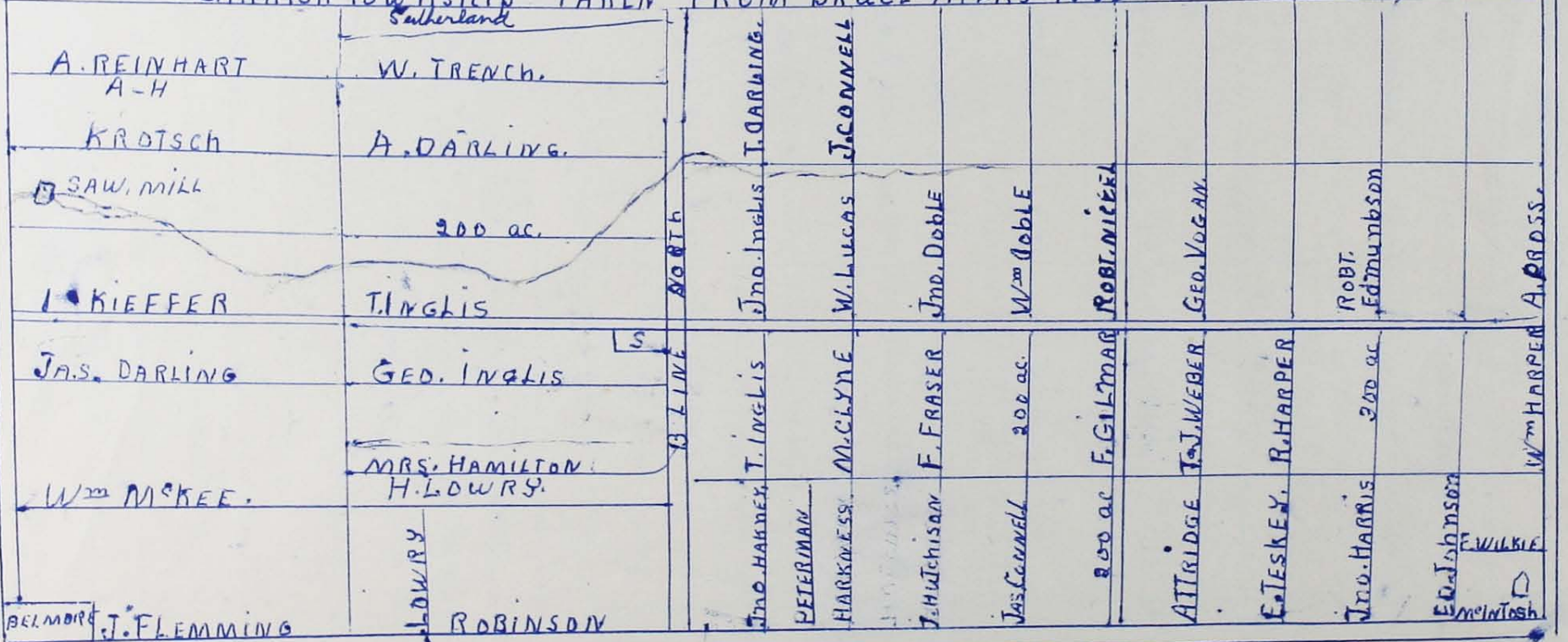

BOUNDARY BETWEEN BRUCE AND HURON AND HOWICK AND CARRICK TOWNSHIPS:

23

Con 2