

# FARM POULTRY

## SOME DISEASES OF POULTRY

Care Should Be Exercised to Prevent Unsanitary Surroundings, Spoiled Food and Dirty Water.

(By H. PRESTON HOSKINS.) Sick birds should be removed from the flock and dead ones burned, in an outbreak of disease.

White diarrhoea of chicks is caused by a germ which is often passed by the hen to the chick through the egg.

Vessels and troughs in which feed is placed should be frequently scalded or disinfected with a five per cent. solution of carbolic acid.

It is a wise precaution to fumigate your incubator with formaldehyde before placing your eggs in it for hatching.

Be careful in introducing new birds into your flock to see that they are perfectly healthy, and not likely to bring disease with them.

The disease called "scaly legs," is caused by a mite belonging to the same family of parasites that cause mange in cattle, sheep, and other farm animals.

A dusting powder for ridding birds of lice may be prepared by mixing equal parts pyrethrum (insect powder) and flowers of sulphur. Apply it with a powder gun.

Poultry diseases, just like other diseases, are favored by unsanitary surroundings, spoiled food, stale and dirty drinking water, and poorly ventilated and insufficiently lighted coops.

## CARE NEEDED FOR GOSLINGS

Several Excellent Little Hints That Go to Make Success With Young Fowls—Keep Them Dry.

Geese require very little food. After they are feathered they need no shelter. I set five goose eggs under each hen to hatch them.

Writes Sarah Peters of Nashville, Kan., in the Farmers Mail and Breese. About a week after eggs have been incubated I dip every egg in a pail of warm water, repeating this at the end of the second week.

Usually we get a gosling for every egg at the end of the hatch, which is 28 to 30 days. As soon as they are dry I take the goslings out of the nest and when all are hatched put them in a small, dry pen, with a large box, the bottom of which is covered with dry earth or sand. They

must have grit, preferably crushed oyster shells. I feed them corn bread soaked in sweet milk and give them sweet milk and water to drink. I put the milk or water in a rather shallow dish with a large stone in the middle of it so the goslings cannot get into it with their feet.

After they are a week old they may be fed on bran mixed with milk. I never turn them out until the dew is off the grass and always shut them up when a rain comes up. They like water but cannot stand being left in the rain or dew.

With the silo we approximate with green, succulent and laxative feed, so we must have June climate, or, in other words we must have warm stables for our cows if we derive the greatest feeding value from ensilage.

Certified Milk. Certified milk always sells for considerably more than does market milk. It has cost more to produce and more to market. From the consumer's standpoint the values are greater. It saves sickness. The food values of fresh, cold, clean milk are as the cow made them. They have not been changed by bacteria, dirt and heat.

Setting Peach Trees. A great many people set peach trees too deeply. The ground should be plowed very deep, but the holes for the trees should only be deep enough to cover the roots well.

Setting Peach Trees. A great many people set peach trees too deeply. The ground should be plowed very deep, but the holes for the trees should only be deep enough to cover the roots well.

Setting Peach Trees. A great many people set peach trees too deeply. The ground should be plowed very deep, but the holes for the trees should only be deep enough to cover the roots well.

Setting Peach Trees. A great many people set peach trees too deeply. The ground should be plowed very deep, but the holes for the trees should only be deep enough to cover the roots well.

Setting Peach Trees. A great many people set peach trees too deeply. The ground should be plowed very deep, but the holes for the trees should only be deep enough to cover the roots well.

Setting Peach Trees. A great many people set peach trees too deeply. The ground should be plowed very deep, but the holes for the trees should only be deep enough to cover the roots well.

Setting Peach Trees. A great many people set peach trees too deeply. The ground should be plowed very deep, but the holes for the trees should only be deep enough to cover the roots well.

Setting Peach Trees. A great many people set peach trees too deeply. The ground should be plowed very deep, but the holes for the trees should only be deep enough to cover the roots well.

Setting Peach Trees. A great many people set peach trees too deeply. The ground should be plowed very deep, but the holes for the trees should only be deep enough to cover the roots well.

Setting Peach Trees. A great many people set peach trees too deeply. The ground should be plowed very deep, but the holes for the trees should only be deep enough to cover the roots well.

Setting Peach Trees. A great many people set peach trees too deeply. The ground should be plowed very deep, but the holes for the trees should only be deep enough to cover the roots well.

Setting Peach Trees. A great many people set peach trees too deeply. The ground should be plowed very deep, but the holes for the trees should only be deep enough to cover the roots well.

Setting Peach Trees. A great many people set peach trees too deeply. The ground should be plowed very deep, but the holes for the trees should only be deep enough to cover the roots well.



## FOR SUCCESS WITH POULTRY

Practical Way of Building Up Laying Strain of Hens is to Breed Them With Best Records.

Trap nests are the best guinea-pigs to success. They point out the hens that are doing good work, and expose the drones. They not only tell you how many eggs each individual hen lays in a year, but they also point out the color of the shell and the shape of the egg.

The time is near at hand when hens will be sold on their egg records, and prices governed accordingly.

It is an accepted fact that the only way to build up a laying strain of hens is to breed from those giving the best records, says the Farm Journal. By annually picking out the best of the flock, it is possible each year to increase the average of the flock.

In line with the introduction of trap nesting came the question of the laying hens giving a better percentage of fertile eggs, as well as receiving an extra allowance of feed. It is more difficult to overfatten a hen that is doing steady laying than it

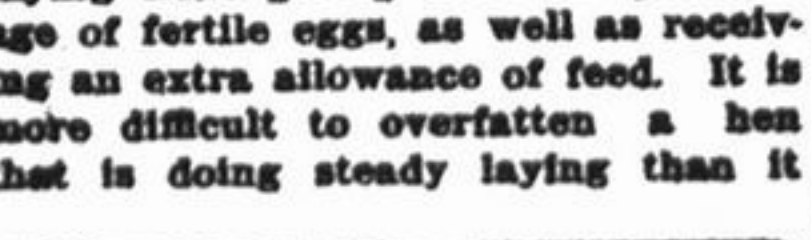

is one that is not laying. It remained for a man by the name of Albert Angell, Jr., to strike the proper idea in this direction.

Briefly stated, this system consists of a house and yard divided into two unequal parts. One side is large enough for 12 hens, and the smaller side is for the cock. In the house are trap nests with two openings. Every night the hens are put in the larger house. The cock stays permanently in his own quarters. Every hen that lays an egg or enters a trap nest goes out into the apartment with the male. When night comes, the laying hens are all with the male and they then are returned to their own side of the house and yard, to go through the same process each day. In the morning the male bird is alone. The trap nest is made by simply fashioning two light doors, using one-inch mesh wire netting. The door to the nest which the hen enters to lay is hinged from the inside, and is pushed open by the hen, and closes behind her. The door in the rear of the nest opening out into the cock's yard, is hinged from the outside. When the hen enters the cock's pen she can not return, as will readily be seen. These doors, or gates, are light, and work easily, and should be the size of the entrance of the next box and hinged to the top.

The illustration, a popular make of trap nests, such as is used on many of the large poultry farms. A shows trap nest turned to open nest. B shows nest closed after hen has entered. C shows trap set.

When a hen is through laying she will stick her head out of the nest and cackle, and should then be released.

On the leg of each hen is placed an aluminum band on which is stamped a number. Upon opening the door of the trap the hen is picked up and her number ascertained. This is then written on the egg, and at night a record is made of these numbers.

On the leg of each hen is placed an aluminum band on which is stamped a number. Upon opening the door of the trap the hen is picked up and her number ascertained. This is then written on the egg, and at night a record is made of these numbers.

On the leg of each hen is placed an aluminum band on which is stamped a number. Upon opening the door of the trap the hen is picked up and her number ascertained. This is then written on the egg, and at night a record is made of these numbers.

On the leg of each hen is placed an aluminum band on which is stamped a number. Upon opening the door of the trap the hen is picked up and her number ascertained. This is then written on the egg, and at night a record is made of these numbers.

On the leg of each hen is placed an aluminum band on which is stamped a number. Upon opening the door of the trap the hen is picked up and her number ascertained. This is then written on the egg, and at night a record is made of these numbers.

On the leg of each hen is placed an aluminum band on which is stamped a number. Upon opening the door of the trap the hen is picked up and her number ascertained. This is then written on the egg, and at night a record is made of these numbers.

On the leg of each hen is placed an aluminum band on which is stamped a number. Upon opening the door of the trap the hen is picked up and her number ascertained. This is then written on the egg, and at night a record is made of these numbers.

On the leg of each hen is placed an aluminum band on which is stamped a number. Upon opening the door of the trap the hen is picked up and her number ascertained. This is then written on the egg, and at night a record is made of these numbers.

On the leg of each hen is placed an aluminum band on which is stamped a number. Upon opening the door of the trap the hen is picked up and her number ascertained. This is then written on the egg, and at night a record is made of these numbers.

On the leg of each hen is placed an aluminum band on which is stamped a number. Upon opening the door of the trap the hen is picked up and her number ascertained. This is then written on the egg, and at night a record is made of these numbers.

On the leg of each hen is placed an aluminum band on which is stamped a number. Upon opening the door of the trap the hen is picked up and her number ascertained. This is then written on the egg, and at night a record is made of these numbers.

On the leg of each hen is placed an aluminum band on which is stamped a number. Upon opening the door of the trap the hen is picked up and her number ascertained. This is then written on the egg, and at night a record is made of these numbers.

On the leg of each hen is placed an aluminum band on which is stamped a number. Upon opening the door of the trap the hen is picked up and her number ascertained. This is then written on the egg, and at night a record is made of these numbers.

On the leg of each hen is placed an aluminum band on which is stamped a number. Upon opening the door of the trap the hen is picked up and her number ascertained. This is then written on the egg, and at night a record is made of these numbers.

On the leg of each hen is placed an aluminum band on which is stamped a number. Upon opening the door of the trap the hen is picked up and her number ascertained. This is then written on the egg, and at night a record is made of these numbers.

On the leg of each hen is placed an aluminum band on which is stamped a number. Upon opening the door of the trap the hen is picked up and her number ascertained. This is then written on the egg, and at night a record is made of these numbers.

On the leg of each hen is placed an aluminum band on which is stamped a number. Upon opening the door of the trap the hen is picked up and her number ascertained. This is then written on the egg, and at night a record is made of these numbers.

On the leg of each hen is placed an aluminum band on which is stamped a number. Upon opening the door of the trap the hen is picked up and her number ascertained. This is then written on the egg, and at night a record is made of these numbers.

## Bound to Grow

Most large business enterprises of today were begun in a small way. Proper banking facilities will help your business grow and prosper. This modern bank gives the same careful attention to small accounts as that is furnished the larger ones—we know they will grow. Whether small or large we want your account.

# FIRST NATIONAL BANK

OF DOWNERS GROVE

J. W. Roger, President. S. Curtiss, Cashier.

Hours—From 8 A. M. to 4. Saturday evenings from 10 to 11 o'clock.

## Mertz & Mochel

HARDWARE  
HARD and SOFT  
COAL  
GRAIN and HAY  
RED COMB POULTRY FEED  
Also  
Washburn-Crosby Co's.  
GOLD MEDAL FLOUR

36 South Main Street  
TELEPHONE 29

## POTATOES

A Carload of Dusky  
Rurals, Fancy Iowa  
Potatoes  
95c a bushel

# F. GERWIG'S

THE NORTH SIDE GROCERY AND MARKET  
TELEPHONE 2 22 NORTH FOREST AVENUE, DOWNERS GROVE, ILL.

## The Blue Front Store

We are Satisfied with a Very Narrow Margin and Quick Sales

By placing our orders for large quantities and for quick settlement we secure the purest, freshest and best goods at the lowest prices and big discounts. We add only one small margin of profit—YOU get the benefit of this low buying.

SPECIALS

Fancy Cranberries, per quart	12c
Fancy Spitzenburg Apples, per peck	60c
Fancy Sweet Louisiana Oranges, per dozen	25c
Fancy Grape Fruit, large size, each 12c, 2 for	20c

# B. E. KEHLER

GENERAL DRY GOODS AND GROCERIES  
Telephone 175 25 South Main Street

Successful dairy management requires intense interest and intellectual advancement. Dairy profits do not consist of growing large crops and donating them unprofitable cows and calling the result profit. A wire strainer is productive of more harm than good. Having clean, fresh cloth strainers for each milking will save a lot of trouble and explain the strange phenomena of why the milk soured. The man who grows legumes to help feed his land has land that yields large crops to feed his cows. Never turn a cow off as unprofitable until you can look her in the eye and say I have done my part in caring for and feeding her. Many men who leave the city to take up farming lose money while they are learning common sense. Weighing, testing, and figuring dairy profits is a comparatively easy matter, but the rest is not so easy to accomplish. It is easy to kill a cow or sell her for a low price and get a new in her place. But to get a better one requires time, money and rare judgment. The tearing down process is more simple than the building up one. Registration is not certification and it has been aptly said that there is no scrub so poor as a pure bred Irish. Actual milk yields are of greater importance than ideal forms, large milk veins and fancy color markings. No small part of the bacterial dirt in milk comes from the person and clothes of the milker. Working contributes more to the steady thrift of cattle than careful and persistent attention to their every day needs. Short pasture, a poor water supply, insufficient shade and protection from flies cause more injury to dairy cattle than disease, parasites and preventable injuries. Good care cannot be administered in bulk. It is the steady every day devotion to the little details that add to the comfort of the cattle that counts. No calling in life brings a man in closer contact with the better class of men than breeding high class stock. It matters not how good a bull may be individually, he cannot head the herd of a painstaking breeder unless he has an acceptable milk record back of his parents. It is quite useless to depend upon purchased cows unless he is a better judge of them offhand than the owner is after testing them, which is surely not often the case. The dairy cows need bulk in her ration, but coarse, woody, indigestible substances cannot be profitably consumed. We need only to give the common cow proper care and feed to learn that instead of being the 150-pound cow she may be a 250-pound cow. This shows that she is far better as a dairy cow than the average man is dairyman. The average skim milk calves are unfortunate victims of ignorance and carelessness in feeding and management. Outside of the fact that a limited amount of fat tends to make the protein in the whole milk more easily digested the value of the fat may be fairly well replaced with cheaper substitutes as soon as the calf's digestive organs have reached a proper development that will enable it to take its nourishment from these foods. When calves begin to scour the first remedial measures should be to clean and scour the pails from which they are fed. Do not feed calves more grain than they will clean up in a short time. Liberal feeding with foods containing plenty of digestible protein and plenty of exercise are conducive to development of a good dairy calf. The calf should have the first milk from its mother, for it possesses certain qualities which are very stimulating to its digestive organs. Let the sunshine and plenty of pure air into the nostrils of dairy cattle and the germs of disease will die for want of a developing place. To adopt modern dairy methods in many communities is likely to invite kindly criticism and sarcastic comment and to inspire jealousies, but in time the example talks and the general situation is bettered. Sun, air, grass and outdoor exercise are required to secure and maintain superb health and vigor in our dairy herds. Inadequate ventilation and inaccessibility of sunlight are equally serious faults in the construction of dairy barns. The first few streams from each cow contain very little fat but very many bacteria. They work their way up the channel of the teat from without and find ideal conditions for their rapid multiplication. If they are milked out on the floor the gross yield may be slightly lessened, but the purity of the milk, so far as bacteria is concerned will be greatly improved. Dairy experimentation shows that no better maker can make high class goods from sour and infrequently delivered cream. Clean, cold milk is the idea of the modern milk producer. When circumstances compel the making of inferior cream into butter pasteurization and special cultures must be used to cover up the evil effects. What are stumbling blocks for others may turn into stepping stones in our own paths of success. The well managed dairy pays profits every month in the year. There is positively no excuse for allowing cows to do business only during the summer, and then tending a lot of dirty, lazy cows all winter with no income from them. If men in other lines of business would stop everything and just keep their plants warm and well lighted we would call them poor business men, but that is just what a great many of dairymen are doing, and wondering why their profits are not larger. With the silo we approximate with green, succulent and laxative feed, so we must have June climate, or, in other words we must have warm stables for our cows if we derive the greatest feeding value from ensilage. Certified Milk. Certified milk always sells for considerably more than does market milk. It has cost more to produce and more to market. From the consumer's standpoint the values are greater. It saves sickness. The food values of fresh, cold, clean milk are as the cow made them. They have not been changed by bacteria, dirt and heat. Setting Peach Trees. A great many people set peach trees too deeply. The ground should be plowed very deep, but the holes for the trees should only be deep enough to cover the roots well.

## GIVE THE DOG COMFORTABLE QUARTERS

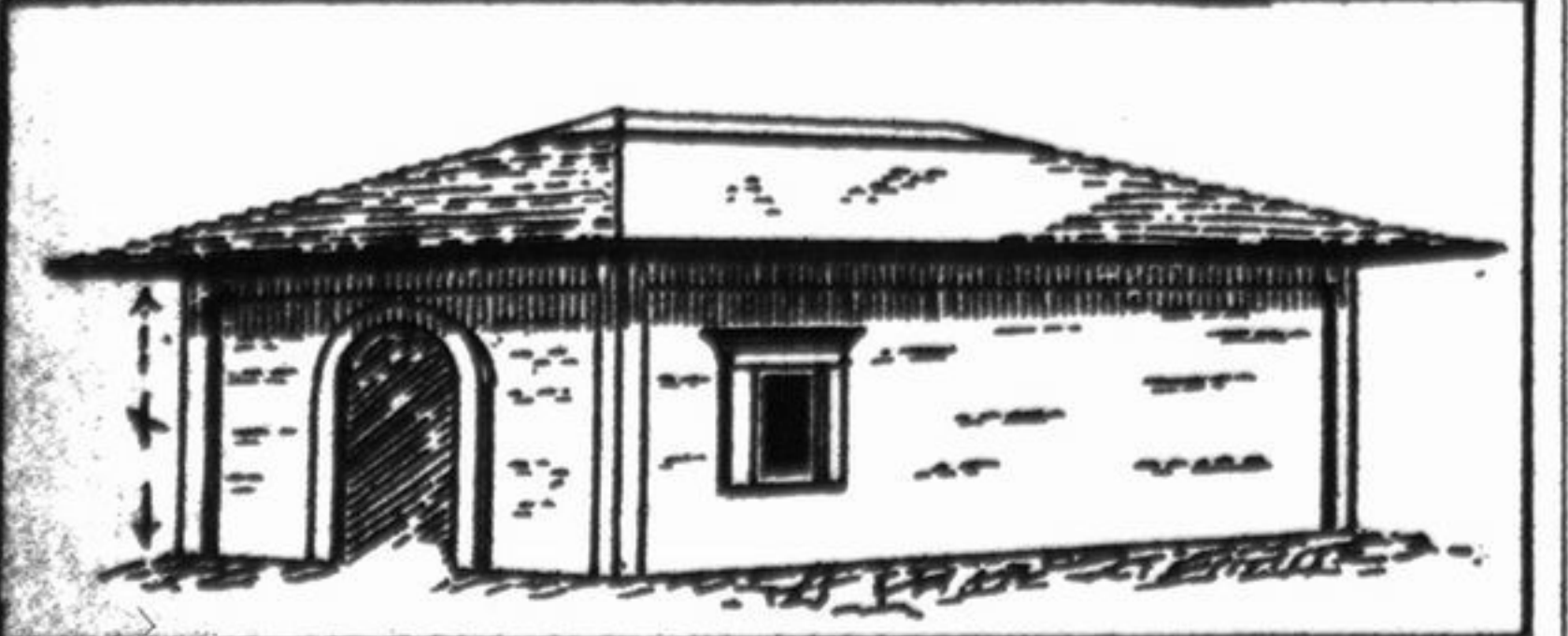

A well-built dog house, which adds to the appearance of the yard. The dog, man's faithful servant, who works "without pay," usually has his sleeping and eating quarters, together with a place where he may find them, and a place where he may find a good bone. In the manner, no intelligent man will construct a dog house that is not comfortable and convenient for the dog. A well built dog house should be built of wood, and should be painted with a good quality of paint. It should be built on a concrete foundation, and should have a door that opens outwards. The dog house should be built in a shady place, and should be well ventilated. It should have a window that is high enough to prevent the dog from looking out, but low enough to allow fresh air to enter. The dog house should be built in a place where the dog can get plenty of exercise, and where he can see his master. It should be built in a place where the dog can get plenty of shade, and where he can get plenty of water. It should be built in a place where the dog can get plenty of protection from the elements, and where he can get plenty of comfort. It should be built in a place where the dog can get plenty of love, and where he can get plenty of attention. It should be built in a place where the dog can get plenty of respect, and where he can get plenty of honor. It should be built in a place where the dog can get plenty of dignity, and where he can get plenty of pride. It should be built in a place where the dog can get plenty of honor, and where he can get plenty of respect. It should be built in a place where the dog can get plenty of love, and where he can get plenty of attention. It should be built in a place where the dog can get plenty of respect, and where he can get plenty of honor. It should be built in a place where the dog can get plenty of dignity, and where he can get plenty of pride. It should be built in a place where the dog can get plenty of honor, and where he can get plenty of respect. It should be built in a place where the dog can get plenty of love, and where he can get plenty of attention. It should be built in a place where the dog can get plenty of respect, and where he can get plenty of honor. It should be built in a place where the dog can get plenty of dignity, and where he can get plenty of pride. It should be built in a place where the dog can get plenty of honor, and where he can get plenty of respect. It should be built in a place where the dog can get plenty of love, and where he can get plenty of attention. It should be built in a place where the dog can get plenty of respect, and where he can get plenty of honor. It should be built in a place where the dog can get plenty of dignity, and where he can get plenty of pride. It should be built in a place where the dog can get plenty of honor, and where he can get plenty of respect. It should be built in a place where the dog can get plenty of love, and where he can get plenty of attention. It should be built in a place where the dog can get plenty of respect, and where he can get plenty of honor. It should be built in a place where the dog can get plenty of dignity, and where he can get plenty of pride. It should be built in a place where the dog can get plenty of honor, and where he can get plenty of respect. It should be built in a place where the dog can get plenty of love, and where he can get plenty of attention. It should be built in a place where the dog can get plenty of respect, and where he can get plenty of honor. It should be built in a place where the dog can get plenty of dignity, and where he can get plenty of pride. It should be built in a place where the dog can get plenty of honor, and where he can get plenty of respect. It should be built in a place where the dog can get plenty of love, and where he can get plenty of attention. It should be built in a place where the dog can get plenty of respect, and where he can get plenty of honor. It should be built in a place where the dog can get plenty of dignity, and where he can get plenty of pride. It should be built in a place where the dog can get plenty of honor, and where he can get plenty of respect. It should be built in a place where the dog can get plenty of love, and where he can get plenty of attention. It should be built in a place where the dog can get plenty of respect, and where he can get plenty of honor. It should be built in a place where the dog can get plenty of dignity, and where he can get plenty of pride. It should be built in a place where the dog can get plenty of honor, and where he can get plenty of respect. It should be built in a place where the dog can get plenty of love, and where he can get plenty of attention. It should be built in a place where the dog can get plenty of respect, and where he can get plenty of honor. It should be built in a place where the dog can get plenty of dignity, and where he can get plenty of pride. It should be built in a place where the dog can get plenty of honor, and where he can get plenty of respect. It should be built in a place where the dog can get plenty of love, and where he can get plenty of attention. It should be built in a place where the dog can get plenty of respect, and where he can get plenty of honor. It should be built in a place where the dog can get plenty of dignity, and where he can get plenty of pride. It should be built in a place where the dog can get plenty of honor, and where he can get plenty of respect. It should be built in a place where the dog can get plenty of love, and where he can get plenty of attention. It should be built in a place where the dog can get plenty of respect, and where he can get plenty of honor. It should be built in a place where the dog can get plenty of dignity, and where he can get plenty of pride. It should be built in a place where the dog can get plenty of honor, and where he can get plenty of respect. It should be built in a place where the dog can get plenty of love, and where he can get plenty of attention. It should be built in a place where the dog can get plenty of respect, and where he can get plenty of honor. It should be built in a place where the dog can get plenty of dignity, and where he can get plenty of pride. It should be built in a place where the dog can get plenty of honor, and where he can get plenty of respect. It should be built in a place where the dog can get plenty of love, and where he can get plenty of attention. It should be built in a place where the dog can get plenty of respect, and where he can get plenty of honor. It should be built in a place where the dog can get plenty of dignity, and where he can get plenty of pride. It should be built in a place where the dog can get plenty of honor, and where he can get plenty of respect. It should be built in a place where the dog can get plenty of love, and where he can get plenty of attention. It should be built in a place where the dog can get plenty of respect, and where he can get plenty of honor. It should be built in a place where the dog can get plenty of dignity, and where he can get plenty of pride. It should be built in a place where the dog can get plenty of honor, and where he can get plenty of respect. It should be built in a place where the dog can get plenty of love, and where he can get plenty of attention. It should be built in a place where the dog can get plenty of respect, and where he can get plenty of honor. It should be built in a place where the dog can get plenty of dignity, and where he can get plenty of pride. It should be built in a place where the dog can get plenty of honor, and where he can get plenty of respect. It should be built in a place where the dog can get plenty of love, and where he can get plenty of attention. It should be built in a place where the dog can get plenty of respect, and where he can get plenty of honor. It should be built in a place where the dog can get plenty of dignity, and where he can get plenty of pride. It should be built in a place where the dog can get plenty of honor, and where he can get plenty of respect. It should be built in a place where the dog can get plenty of love, and where he can get plenty of attention. It should be built in a place where the dog can get plenty of respect, and where he can get plenty of honor. It should be built in a place where the dog can get plenty of dignity, and where he can get plenty of pride. It should be built in a place where the dog can get plenty of honor, and where he can get plenty of respect. It should be built in a place where the dog can get plenty of love, and where he can get plenty of attention. It should be built in a place where the dog can get plenty of respect, and where he can get plenty of honor. It should be built in a place where the dog can get plenty of dignity, and where he can get plenty of pride. It should be built in a place where the dog can get plenty of honor, and where he can get plenty of respect. It should be built in a place where the dog can get plenty of love, and where he can get plenty of attention. It should be built in a place where the dog can get plenty of respect, and where he can get plenty of honor. It should be built in a place where the dog can get plenty of dignity, and where he can get plenty of pride. It should be built in a place where the dog can get plenty of honor, and where he can get plenty of respect. It should be built in a place where the dog can get plenty of love, and where he can get plenty of attention. It should be built in a place where the dog can get plenty of respect, and where he can get plenty of honor. It should be built in a place where the dog can get plenty of dignity, and where he can get plenty of pride. It should be built in a place where the dog can get plenty of honor, and where he can get plenty of respect. It should be built in a place where the dog can get plenty of love, and where he can get plenty of attention. It should be built in a place where the dog can get plenty of respect, and where he can get plenty of honor. It should be built in a place where the dog can get plenty of dignity, and where he can get plenty of pride. It should be built in a place where the dog can get plenty of honor, and where he can get plenty of respect. It should be built in a place where the dog can get plenty of love, and where he can get plenty of attention. It should be built in a place where the dog can get plenty of respect, and where he can get plenty of honor. It should be built in a place where the dog can get plenty of dignity, and where he can get plenty of pride. It should be built in a place where the dog can get plenty of honor, and where he can get plenty of respect. It should be built in a place where the dog can get plenty of love, and where he can get plenty of attention. It should be built in a place where the dog can get plenty of respect, and where he can get plenty of honor. It should be built in a place where the dog can get plenty of dignity, and where he can get plenty of pride. It should be built in a place where the dog can get plenty of honor, and where he can get plenty of respect. It should be built in a place where the dog can get plenty of love, and where he can get plenty of attention. It should be built in a place where the dog can get plenty of respect, and where he can get plenty of honor. It should be built in a place where the dog can get plenty of dignity, and where he can get plenty of pride. It should be built in a place where the dog can get plenty of honor, and where he can get plenty of respect. It should be built in a place where the dog can get plenty of love, and where he can get plenty of attention. It should be built in a place where the dog can get plenty of respect, and where he can get plenty of honor. It should be built in a place where the dog can get plenty of dignity, and where he can get plenty of pride. It should be built in a place where the dog can get plenty of honor, and where he can get plenty of respect. It should be built in a place where the dog can get plenty of love, and where he can get plenty of attention. It should be built in a place where the dog can get plenty of respect, and where he can get plenty of honor. It should be built in a place where the dog can get plenty of dignity, and where he can get plenty of pride. It should be built in a place where the dog can get plenty of honor, and where he can get plenty of respect. It should be built in a place where the dog can get plenty of love, and where he can get plenty of attention. It should be built in a place where the dog can get plenty of respect, and where he can get plenty of honor. It should be built in a place where the dog can get plenty of dignity, and where he can get plenty of pride. It should be built in a place where the dog can get plenty of honor, and where he can get plenty of respect. It should be built in a place where the dog can get plenty of love, and where he can get plenty of attention. It should be built in a place where the dog can get plenty of respect, and where he can get plenty of honor. It should be built in a place where the dog can get plenty of dignity, and where he can get plenty of pride. It should be built in a place where the dog can get plenty of honor, and where he can get plenty of respect. It should be built in a place where the dog can get plenty of love, and where he can get plenty of attention. It should be built in a place where the dog can get plenty of respect, and where he can get plenty of honor. It should be built in a place where the dog can get plenty of dignity, and where he can get plenty of pride. It should be built in a place where the dog can get plenty of honor, and where he can get plenty of respect. It should be built in a place where the dog can get plenty of love, and where he can get plenty of attention. It should be built in a place where the dog can get plenty of respect, and where he can get plenty of honor. It should be built in a place where the dog can get plenty of dignity, and where he can get plenty of pride. It should be built in a place where the dog can get plenty of honor, and where he can get plenty of respect. It should be built in a place where the dog can get plenty of love, and where he can get plenty of attention. It should be built in a place where the dog can get plenty of respect, and where he can get plenty of honor. It should be built in a place where the dog can get plenty of dignity, and where he can get plenty of pride. It should be built in a place where the dog can get plenty of honor, and where he can get plenty of respect. It should be built in a place where the dog can get plenty of love, and where he can get plenty of attention. It should be built in a place where the dog can get plenty of respect, and where he can get plenty of honor. It should be built in a place where the dog can get plenty of dignity, and where he can get plenty of pride. It should be built in a place where the dog can get plenty of honor, and where he can get plenty of respect. It should be built in a place where the dog can get plenty of love, and where he can get plenty of attention. It should be built in a place where the dog can get plenty of respect, and where he can get plenty of honor. It should be built in a place where the dog can get plenty of dignity, and where he can get plenty of pride. It should be built in a place where the dog can get plenty of honor, and where he can get plenty of respect. It should be built in a place where the dog can get plenty of love, and where he can get plenty of attention. It should be built in a place where the dog can get plenty of respect, and where he can get plenty of honor. It should be built in a place where the dog can get plenty of dignity, and where he can get plenty of pride. It should be built in a place where the dog can get plenty of honor, and where he can get plenty of respect. It should be built in a place where the dog can get plenty of love, and where he can get plenty of attention. It should be built in a place where the dog can get plenty of respect, and where he can get plenty of honor. It should be built in a place where the dog can get plenty of dignity, and where he can get plenty of pride. It should be built in a place where the dog can get plenty of honor, and where he can get plenty of respect. It should be built in a place where the dog can get plenty of love, and where he can get plenty of attention. It should be built in a place where the dog can get plenty of respect, and where he can get plenty of honor. It should be built in a place where the dog can get plenty of dignity, and where he can get plenty of pride. It should be built in a place where the dog can get plenty of honor, and where he can get plenty of respect. It should be built in a place where the dog can get plenty of love, and where he can get plenty of attention. It should be built in a place where the dog can get plenty of respect, and where he can get plenty of honor. It should be built in a place where the dog can get plenty of dignity, and where he can get plenty of pride. It should be built in a place where the dog can get plenty of honor, and where he can get plenty of respect. It should be built in a place where the dog can get plenty of love, and where he can get plenty of attention. It should be built in a place where the dog can get plenty of respect, and where he can get plenty of honor. It should be built in a place where the dog can get plenty of dignity, and where he can get plenty of pride. It should be built in a place where the dog can get plenty of honor, and where he can get plenty of respect. It should be built in a place where the dog can get plenty of love, and where he can get plenty of attention. It should be built in a place where the dog can get plenty of respect, and where he can get plenty of honor. It should be built in a place where the dog can get plenty of dignity, and where he can get plenty of pride. It should be built in a place where the dog can get plenty of honor, and where he can get plenty of respect. It should be built in a place where the dog can get plenty of love, and where he can get plenty of attention. It should be built in a place where the dog can get plenty of respect, and where he can get plenty of honor. It should be built in a place where the dog can get plenty of dignity, and where he can get plenty of pride. It should be built in a place where the dog can get plenty of honor, and where he can get plenty of respect. It should be built in a place where the dog can get plenty of love, and where he can get plenty of attention. It should be built in a place where the dog can get plenty of respect, and where he can get plenty of honor. It should be built in a place where the dog can get plenty of dignity, and where he can get plenty of pride. It should be built in a place where the dog can get plenty of honor, and where he can get plenty of respect. It should be built in a place where the dog can get plenty of love, and where he can get plenty of attention. It should be built in a place where the dog can get plenty of respect, and where he can get plenty of honor. It should be built in a place where the dog can get plenty of dignity, and where he can get plenty of pride. It should be built in a place where the dog can get plenty of honor, and where he can get plenty of respect. It should be built in a place where the dog can get plenty of love, and where he can get plenty of attention. It should be built in a place where the dog can get plenty of respect, and where he can get plenty of honor. It should be built in a place where the dog can get plenty of dignity, and where he can get plenty of pride. It should be built in a place where the dog can get plenty of honor, and where he can get plenty of respect. It should be built in a place where the dog can get plenty of love, and where he can get plenty of attention. It should be built in a place where the dog can get plenty of respect, and where he can get plenty of honor. It should be built in a place where the dog can get plenty of dignity, and where he can get plenty of pride. It should be built in a place where the dog can get plenty of honor, and where he can get plenty of respect. It should be built in a place where the dog can get plenty of love, and where he can get plenty of attention. It should be built in a place where the dog can get plenty of respect, and where he can get plenty of honor. It should be built in a place where the dog can get plenty of dignity, and where he can get plenty of pride. It should be built in a place where the dog can get plenty of honor, and where he can get plenty of respect. It should be built in a place where the dog can get plenty of love, and where he can get plenty of attention. It should be built in a place where the dog can get plenty of respect, and where he can get plenty of honor. It should be built in a place where the dog can get plenty of dignity, and where he can get plenty of pride. It should be built in a place where the dog can get plenty of honor, and where he can get plenty of respect. It should be built in a place where the dog can get plenty of love, and where he can get plenty of attention. It should be built in a place where the dog can get plenty of respect, and where he can get plenty of honor. It should be built in a place where the dog can get plenty of dignity, and where he can get plenty of pride. It should be built in a place where the dog can get plenty of honor, and where he can get plenty of respect. It should be built in a place where the dog can get plenty of love, and where he can get plenty of attention. It should be built in a place where the dog can get plenty of respect, and where he can get plenty of honor. It should be built in a place where the dog can get plenty of dignity, and where he can get plenty of pride. It should be built in a place where the dog can get plenty of honor, and where he can get plenty of respect. It should be built in a place where the dog can get plenty of love, and where he can get plenty of attention. It should be built in a place where the dog can get plenty of respect, and where he can get plenty of honor. It should be built in a place where the dog can get plenty of dignity, and where he can get plenty of pride. It should be built in a place where the dog can get plenty of honor, and where he can get plenty of respect. It should be built in a place where the dog can get plenty of love, and where he can get plenty of attention. It should be built in a place where the dog can get plenty of respect, and where he can get plenty of honor. It should be built in a place where the dog can get plenty of dignity, and where he can get plenty of pride. It should be built in a place where the dog can get plenty of honor, and where he can get plenty of respect. It should be built in a place where the dog can get plenty of love, and where he can get plenty of attention. It should be built in a place where the dog can get plenty of respect, and where he can get plenty of honor. It should be built in a place where the dog can get plenty of dignity, and where he can get plenty of pride. It should be built in a place where the dog can get plenty of honor, and where he can get plenty of