

# BURLINGTON'S CENTENNIAL BUSINESS PARK

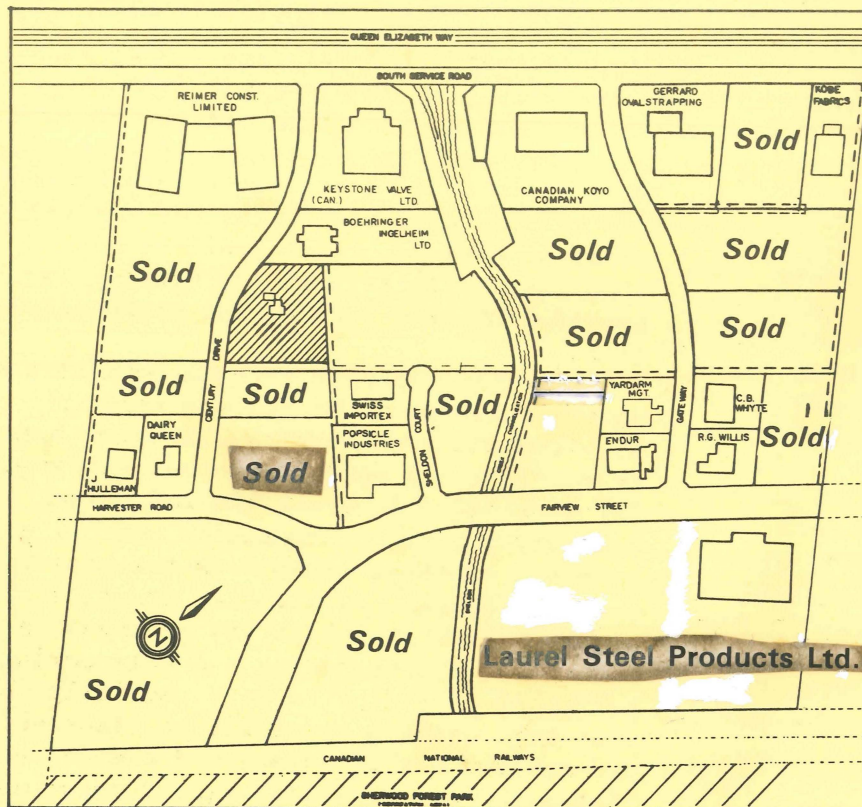

- 117 acre planned industrial park
- Municipally owned and fully serviced
- Strategically sited adjacent to major road and rail routes
- Restricted as to use and design — to provide security for your investment
- A business climate favourable to growth

... plus the technical services of our Municipal Departments to assist with special problems.

For latest information on site availabilities — contact Mrs. Mary Dillon, Manager, Business Services Division, Box 5013, Burlington, Ontario, Canada L7R 3Z6. Phone (416)335-7711.

BURLINGTON BUSINESS SERVICES DIVISION,  
BOX 5013, BURLINGTON, ONTARIO L7R 3Z6

Please Deliver to —



**Business  
grows . . .  
and grows . . .  
in Beautiful  
Burlington.**